



NO. of Contacts	Dimension(mm)			
	A±0.10	B±0.10	C±0.10	D±0.10
8	5.10	2.40	4.20	3.60
10	5.90	3.20	5.00	4.40
12	6.70	4.00	5.80	5.20
14	7.50	4.80	6.60	6.00
16	8.30	5.60	7.40	6.80
18	9.10	6.40	8.20	7.60
20	9.90	7.20	9.00	8.40
22	10.70	8.00	9.80	9.20
24	11.50	8.80	10.60	10.00
26	12.30	9.60	11.40	10.80
28	13.10	10.40	12.20	11.60
30	13.90	11.20	13.00	12.40
32	14.70	12.00	13.80	13.20
34	15.50	12.80	14.60	14.00
36	16.30	13.60	15.40	14.80
38	17.10	14.40	16.20	15.60
40	17.90	15.20	17.00	16.40
42	18.70	16.00	17.80	17.20
44	19.50	16.80	18.60	18.00
46	20.30	17.60	19.40	18.80
48	21.10	18.40	20.20	19.60
50	21.90	19.20	21.00	20.40
52	22.70	20.00	21.80	21.20
54	23.50	20.80	22.60	22.00
56	24.30	21.60	23.40	22.80
58	25.10	22.40	24.20	23.60
60	25.90	23.20	25.00	24.40
62	26.70	24.00	25.80	25.20
64	27.50	24.80	26.60	26.00
66	28.30	25.60	27.40	26.80
68	29.10	26.40	28.20	27.60
70	29.90	27.20	29.00	28.40
72	30.70	28.00	29.80	29.20
74	31.50	28.80	30.60	30.00
76	32.30	29.60	31.40	30.80
78	33.10	30.40	32.20	31.60
80	33.90	31.20	33.00	32.40
82	34.70	32.00	33.80	33.20
84	35.50	32.80	34.60	34.00
86	36.30	33.60	35.40	34.80
88	37.10	34.40	36.20	35.60
90	37.90	35.20	37.00	36.40
92	38.70	36.00	37.80	37.20
94	39.50	36.80	38.60	38.00
96	40.30	37.60	39.40	38.80
98	41.10	38.40	40.20	39.60
100	41.90	39.20	41.00	40.40

PART NUMBER CODING

BTC02M XXX-XXX XX X X 1

Housing High male=H2
 No. of Pins
 Contact Plating
 G0=2u" Gold
 G1=3u" Gold
 G2=5u" Gold
 G3=10u" Gold
 G4=15u" Gold
 G5=30u" Gold
 G6=30u" Gold
 Insulator Material/Colour
 E=PA9T/White
 F=PA9T/Black
 Packing
 T:Tube+CAP
 R:Tape&Reel+CAP

High photosynthesis (H)	The female seat height (H1)	The male seat height (H2)	Insertion height (H3)
3.5	2.5	1.0	1.9
4.0	3.0	1.0	1.9
4.5	3.5	1.0	1.9
5.0	3.0	2.0	1.9
5.5	3.5	2.0	1.9
6.0	4.0	2.0	1.9
6.5	4.5	2.0	1.9

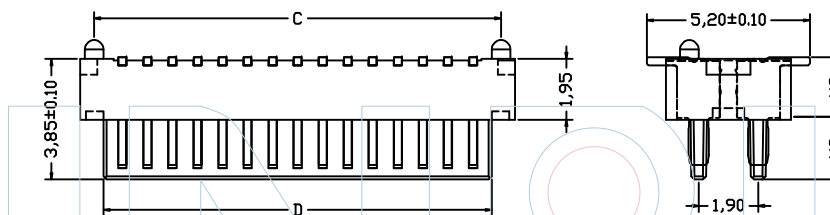
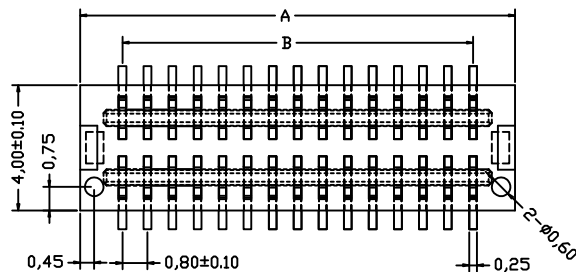

ASSEMBLY

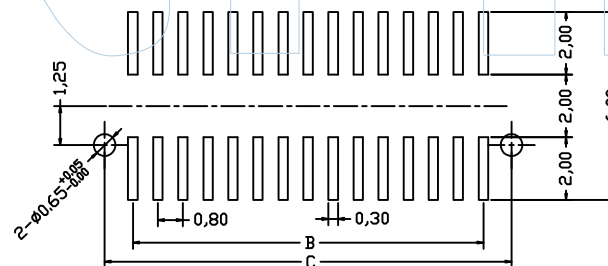
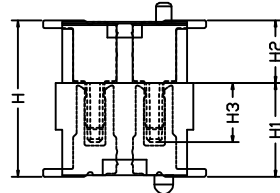

P.C.B PATTEN



Tel: +86 769 82581808 FAX: +86 769 81766192
 E-Mail: winpin@win-pin.com Http://www.win-pin.com

PART NO: BTC02MXXX-XXXXXXX1

TITLE: 0.80mm B TO B "T" MALE 180°SMT TYPE

NOTES:
 Current Rating: .0.5AMP
 Voltage Rating: 50V AC/DC
 Contact Resistance: 50mΩ max
 Insulation Resistance: 100MΩ Min
 Operation Temperature: -20°C to +105°C

Housing Material: PA9T (UL94V-0),
 Contact Material: Phosphor Bronze
 Contact plating: Au or Sn over Ni

UNLESS OTHERWISE SPECIFIED DIMENSIONS ARE IN METRIC TOLERANCES ARE:

DECIMALS Angle
 X.X: ±0.40 ± 3°
 X.XX: ±0.25
 X.XXX: ±0.15

SCALE 1:1
 UNIT MM
 PROJ.
 SHEET

A0	2015/06/25	NEW	Hua.ZT		Hua.ZT
REV	DATE	MODIFICATION DESCRIPTIO	DRAW	CHANGE	APPROVE