

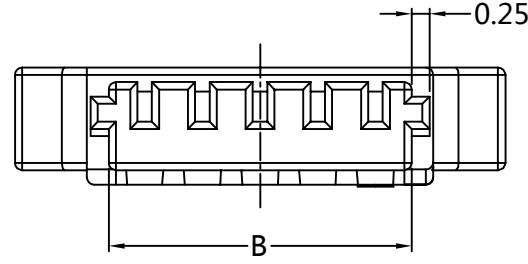

PART NUMBER CODING  
**H08001-1 XX X 3**

No. of pins  
 02-20P  
 Color  
 W=White

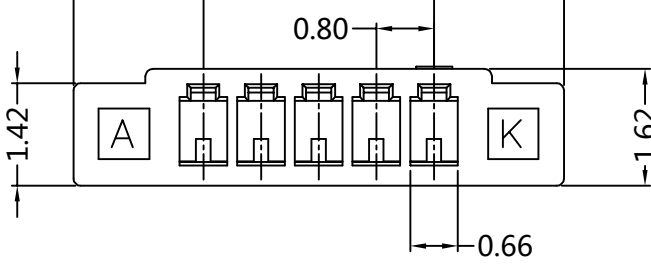
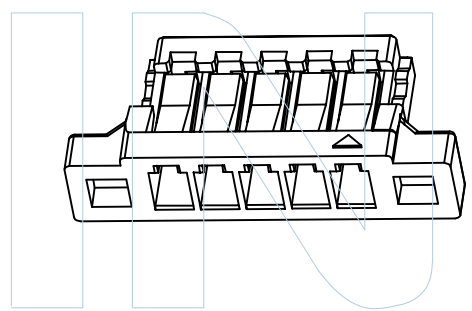
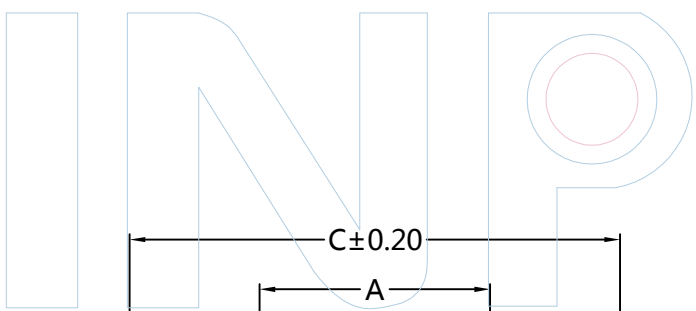
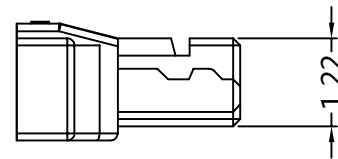
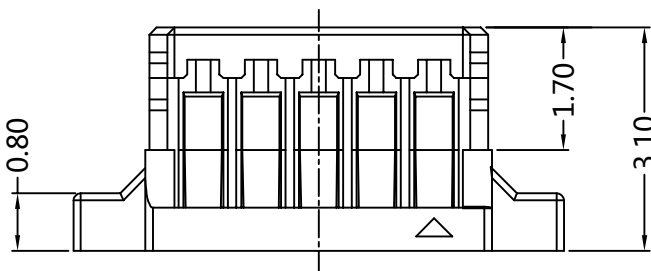

Dimensions(mm)

POLES	A	B	C	POLES	A	B	C
2P	0.80	1.80	4.40	12P	8.80	9.80	12.40
3P	1.60	2.60	5.20	13P	9.60	10.60	13.20
4P	2.40	3.40	6.00	14P	10.40	11.40	14.00
5P	3.20	4.20	6.80	15P	11.20	12.20	14.80
6P	4.00	5.00	7.60	16P	12.00	13.00	15.60
7P	4.80	5.80	8.40	17P	12.80	13.80	16.40
8P	5.60	6.60	9.20	18P	13.60	14.60	17.20
9P	6.40	7.40	10.00	19P	14.40	15.40	18.00
10P	7.20	8.20	10.80	20P	15.20	16.20	18.80
11P	8.00	9.00	11.60				



Tel: +86 769 82581808 FAX: +86 769 81766192  
 E-Mail: sales@winpin.net Http: www.winpin.net

PART NO: H08001-1XXX3

TITLE: 0.8mm Crimp Housing 有耳

NOTES:  
 Current Rating:0.5A  
 Withstand Voltage:200V AC/DC  
 Rated Voltage:30V AC/DC  
 Contact Resistance:20mΩ Max  
 Insulation Resistance:100MQ Min  
 Operation Temperature:-40°C to +105°C  
 Applicable Terminal:T08001-PXX2

Insulator Material:PA46 (UL94V-0)

UNLESS OTHERWISE SPECIFIED DIMENSIONS ARE IN METRIC  
 TOLERANCES ARE:  
 DECIMALS Angle  
 X.X:±0.40 ± 3°  
 X.XX:±0.25  
 X.XXX:±0.15

SCALE 1:1  
 UNIT MM  
 PROJ.   
 SHEET

A0	2020/06/25	NEW	Jason.Huang	Jason.Huang
REV	DATE	MODIFICATION DESCRIPTIO	DRAW	CHANGE APPROVE



# PART NUMBER CODING T08001-P XX 2

Contact plating  
 G0:Gold Flash  
 G1:3U"Gold  
 G2:5U"Gold  
 G3:10U"Gold  
 G4:15U"Gold  
 G5:20U"Gold  
 G6:30U"Gold  
 S0:Gold Flash/Tin  
 S1:3U"Gold/Tin  
 S2:5U"Gold/Tin  
 S3:10U"Gold/Tin  
 S4:15U"Gold/Tin  
 S6:30U"Gold/Tin  
 SN:Tin

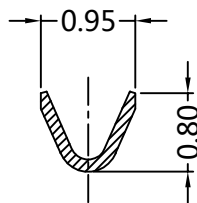
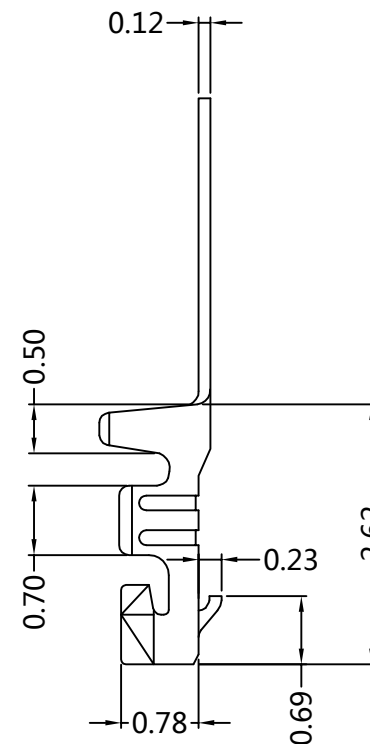
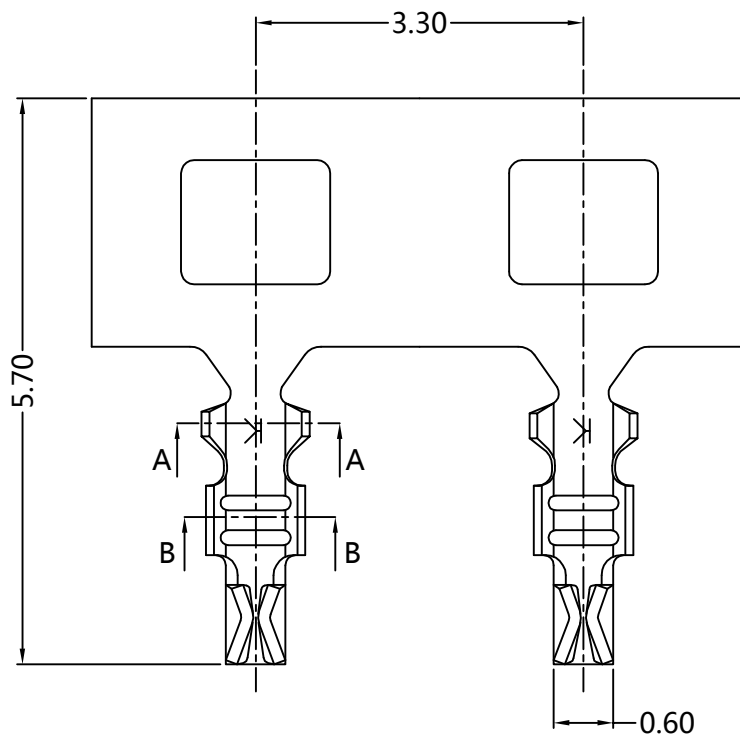

SECTION: B-B

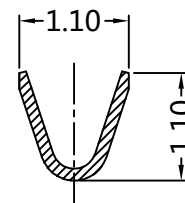

SECTION: A-A



Tel: +86 769 82581808  
 E-Mail: sales@winpin.net

FAX: +86 769 81766192  
 Http: www.winpin.net

PART NO: T08001-PXX2

TITLE: 0.8mm Crimp terminal

NOTES:  
 Current Rating: 1.5A  
 Withstand Voltage: 500V AC/DC  
 Rated Voltage: 50V AC/DC  
 Contact Resistance: 20mΩ Max  
 Insulation Resistance: 100MΩ Min  
 Operation Temperature: -40°C to +105°C  
 Applicable Wires: AWG#32(OD 0.60MAX.)  
 Applicable Housing: H08001-1XXX2

Material: Phosphor Bronze  
 Finish: Tin plated

UNLESS OTHERWISE SPECIFIED DIMENSIONS ARE IN METRIC  
 TOLERANCES ARE:  
 DECIMALS Angle  
 X.X: ±0.40 ± 3°  
 X.XX: ±0.25  
 X.XXX: ±0.15

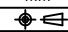
SCALE 1:1  
 UNIT MM  
 PROJ.   
 SHEET

A0	2020/06/25	NEW	Jason.Huang	Jason.Huang
REV	DATE	MODIFICATION DESCRIPTIO	DRAW	CHANGE
APPROVE				