



### PART NUMBER CODING

IDC6 X- XX XX X X X 1

TYPE  
1:With Bump  
2:w/o Bump

No.of Pins  
10-50P

Contact Plating  
S0:Gold Flash/Ni  
S1:3U\*Gold/Ni  
S2:5U\*Gold/Ni  
S3:10U\*Gold/Ni  
S4:15U\*Gold/Ni  
S5:20U\*Gold/Ni  
S6:30U\*Gold/Ni

Color  
B:Black  
G:Grey

TYPE  
2:W/O SR  
3:With SR

Packing  
A:Tray

Pins	Dimensions			
	A	B	C	D
10	16.65	8.00	11.65	15.20
12	18.65	10.00	13.65	17.20
14	20.65	12.00	15.65	19.20
16	22.65	14.00	17.65	21.20
18	24.65	16.00	19.65	23.20
20	26.65	18.00	21.65	25.20
22	28.65	20.00	23.65	27.20
24	30.65	22.00	25.65	29.20
26	32.65	24.00	27.65	31.20
28	34.65	26.00	29.65	33.20
30	36.65	28.00	31.65	35.20
34	40.65	32.00	35.65	39.20
40	46.65	38.00	40.65	45.20
44	50.65	42.00	45.65	49.20
50	56.65	58.00	51.65	55.20

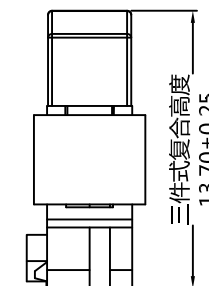
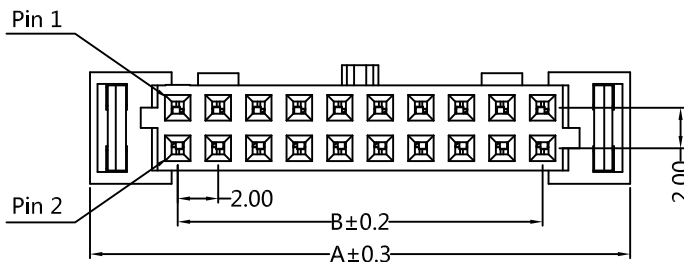
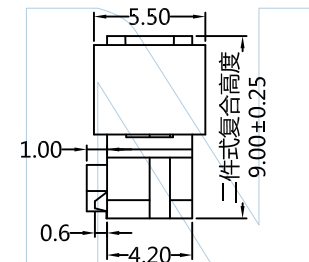
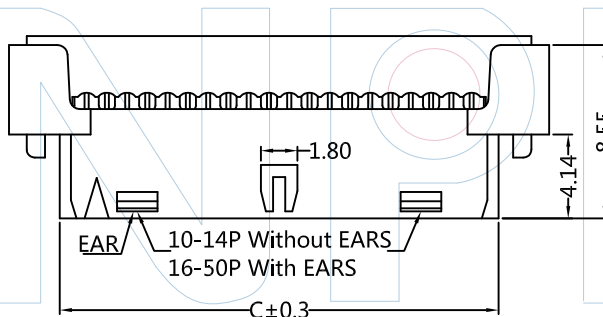
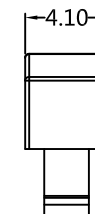
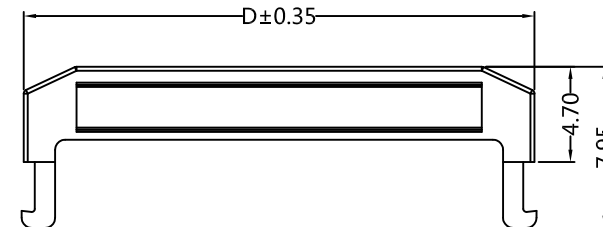
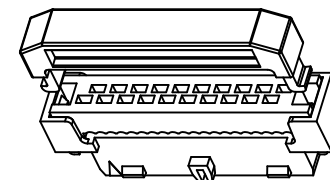
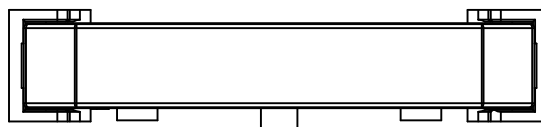

Tel:+86 769 82581808 FAX:+86 769 81766192  
E-Mail:sales@winpin.net Http://www.winpin.net

PART NO: IDC6X-XXXXXXX1

TITLE: 2.00mm IDC Socket "M" TYPE (With Ramp Locking)

NOTES:  
Current Rating:1.0AMP  
Withstand Voltage:500V AC/DC  
Contact Resistance:20mΩ Max  
Insulation Resistance:1000MΩ Min  
Operation Temperature:-40°C to +105°C

MATERIAL:  
Contact Material:Brass  
Contact Plating:Au over Ni  
Insulator Material:PBT+30%GF(UL94V-0)

UNLESS OTHERWISE SPECIFIED DIMENSIONS ARE IN METRIC  
TOLERANCES ARE:  
DECIMALS Angle  
X.X:±0.40 ± 3°  
X.XX:±0.25  
X.XXX:±0.15

SCALE 1:1  
UNIT MM  
PROJ.   
SHEET

A0	2015/06/25	NEW	Myron.Yuan	Myron.Yuan
REV	DATE	MODIFICATION DESCRIPTION	DRAW	CHANGE APPROVE