



PART NUMBER CODING

H25022-1 XX X 1

No. of pins
02-15P

Color
W=White

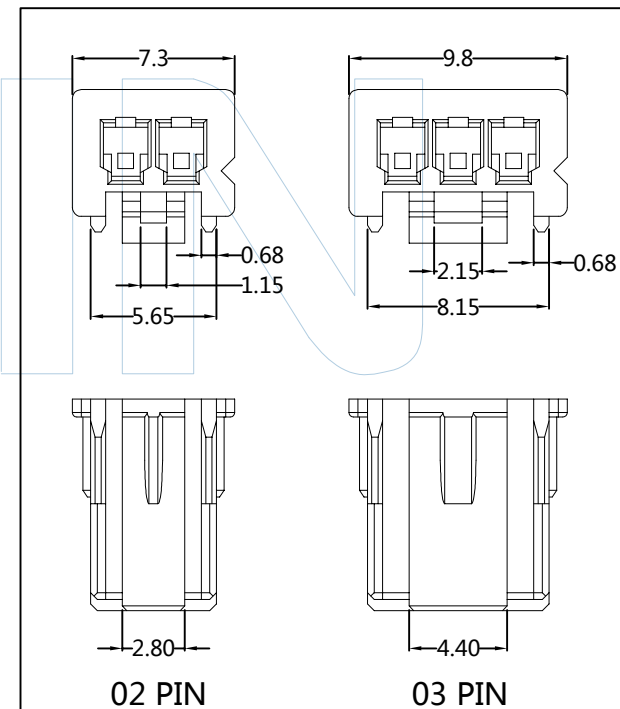
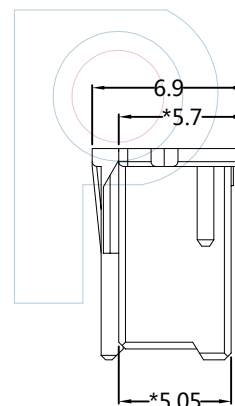
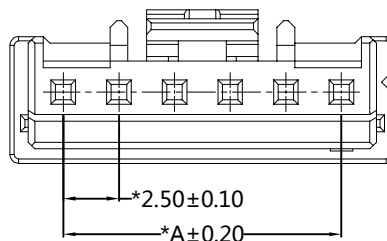
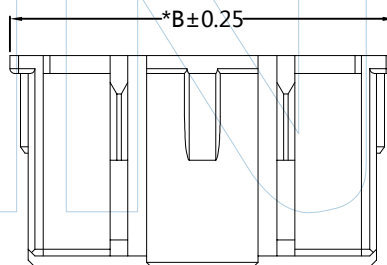
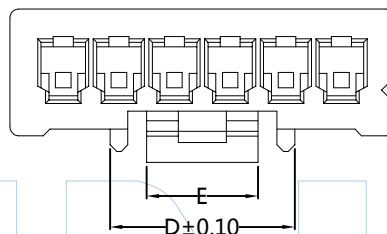
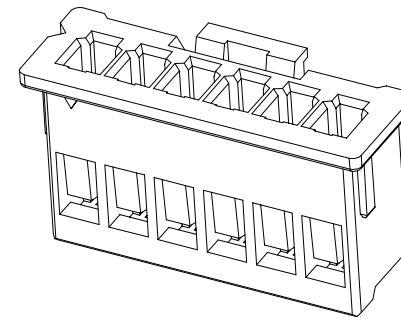
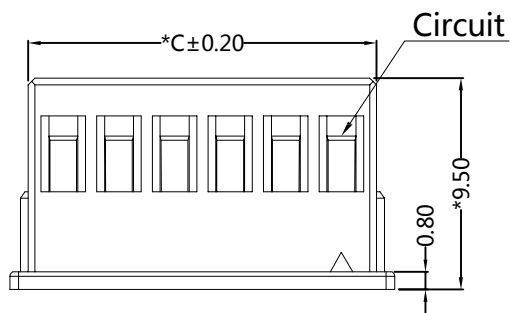

Pins	Dimensions				
	A	B	C	D	E
02	2.50	7.30	5.65	5.65	2.80
03	5.00	9.80	8.15	8.15	4.40
04	7.50	12.30	10.65	8.30	5.00
05	10.00	14.80	13.15	8.30	5.00
06	12.50	17.30	15.65	8.30	5.00
07	15.00	19.80	18.15	8.30	5.00
08	17.50	22.30	20.65	8.30	5.00
09	20.00	24.80	23.15	8.30	5.00
10	22.50	27.30	25.65	8.30	5.00
11	25.00	29.80	28.15	8.30	5.00
12	27.50	32.30	30.65	8.30	5.00
13	30.00	34.80	33.15	8.30	5.00
14	32.50	37.30	35.65	8.30	5.00
15	35.00	39.80	38.15	8.30	5.00



Tel: +86 769 82581808 FAX: +86 769 81766192
E-Mail: sales@winpin.net Http: www.winpin.net

PART NO: H25022-1XXX1

TITLE: XA 2.5mm Housing

NOTE:
Current Rating: 3.0A AC/DC
Voltage Rating: 250V AC/DC
Withstand Voltage: 1000V AC/Minute
Insulation Resistance: 1000MΩ Min
Working Temperature: -25°C~+85°C
Mark "*" as the key size

MATERIAL:
Insulator : PA66(UL94V-0)

UNLESS OTHERWISE SPECIFIED DIMENSIONS ARE IN METRIC TOLERANCES ARE:
DECIMALS Angle
X.X: ±0.40 ± 3°
X.XX: ±0.25
X.XXX: ±0.15

SCALE	1:1
UNIT	MM
PROJ.	
SHEET	

A0	2021/05/07	NEW	GF.He		Andy
REV	DATE	MODIFICATION DESCRIPTION	DRAW	CHANGE	APPROVE



PART NUMBER CODING H25022-1 XX X 2

No. of pins
02-14P
Color
B=Black

Pins	Dimensions		
	A	B	C
02	2.50	3.80	--
03	5.00	6.30	--
04	7.50	11.30	--
05	10.00	13.80	--
06	12.50	16.30	7.50
07	15.00	18.80	10.00
08	17.50	21.30	12.50
09	20.00	23.80	15.00
10	22.50	26.30	15.00
11	25.00	28.80	20.00
12	27.50	31.30	22.50
13	30.00	33.80	25.00
14	32.50	36.30	27.50

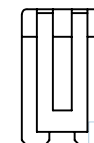
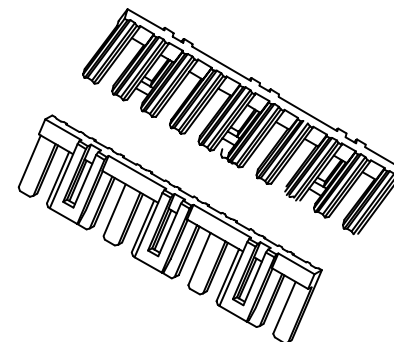
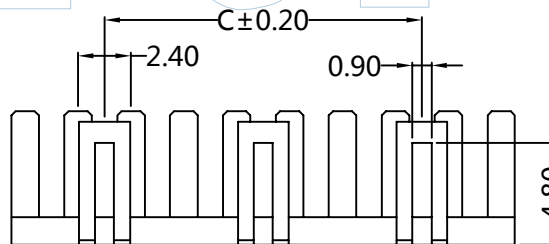
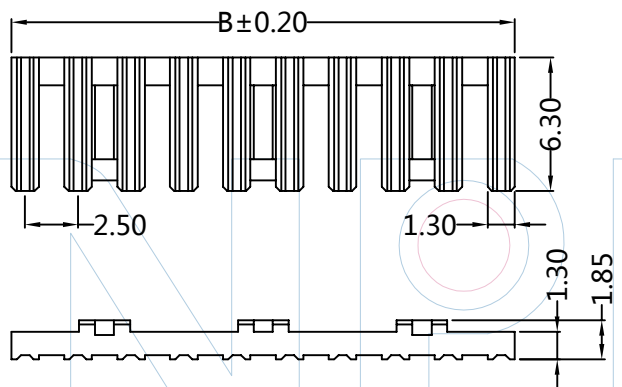
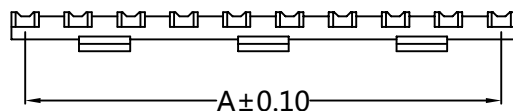

2-5PIN

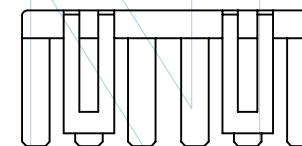

6-8PIN

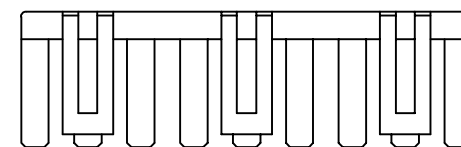

9-14PIN



Tel: +86 769 82581808 FAX: +86 769 81766192
E-Mail: sales@winpin.net Http: www.winpin.net

PART NO: H25022-1XXX2

TITLE: XA 2.5mm Housing

NOTE:
Current Rating: 3.0A AC/DC
Voltage Rating: 250V AC/DC
Withstand Voltage: 1000V AC/Minute
Insulation Resistance: 1000MΩ Min
Working Temperature: -25°C ~ +85°C

MATERIAL:
Insulator : PA66(Ul94V-0)

UNLESS OTHERWISE SPECIFIED DIMENSIONS ARE IN METRIC
TOLERANCES ARE:
DECIMALS Angle
X.X: ±0.40 ± 3°
X.XX: ±0.25
X.XXX: ±0.15

SCALE 1:1
UNIT MM
PROJ.
SHEET

A0	2021/05/07	NEW	GF.He	Andy	
REV	DATE	MODIFICATION DESCRIPTIO	DRAW	CHANGE	APPROVE



PART NUMBER CODING
T25022-P XX 1

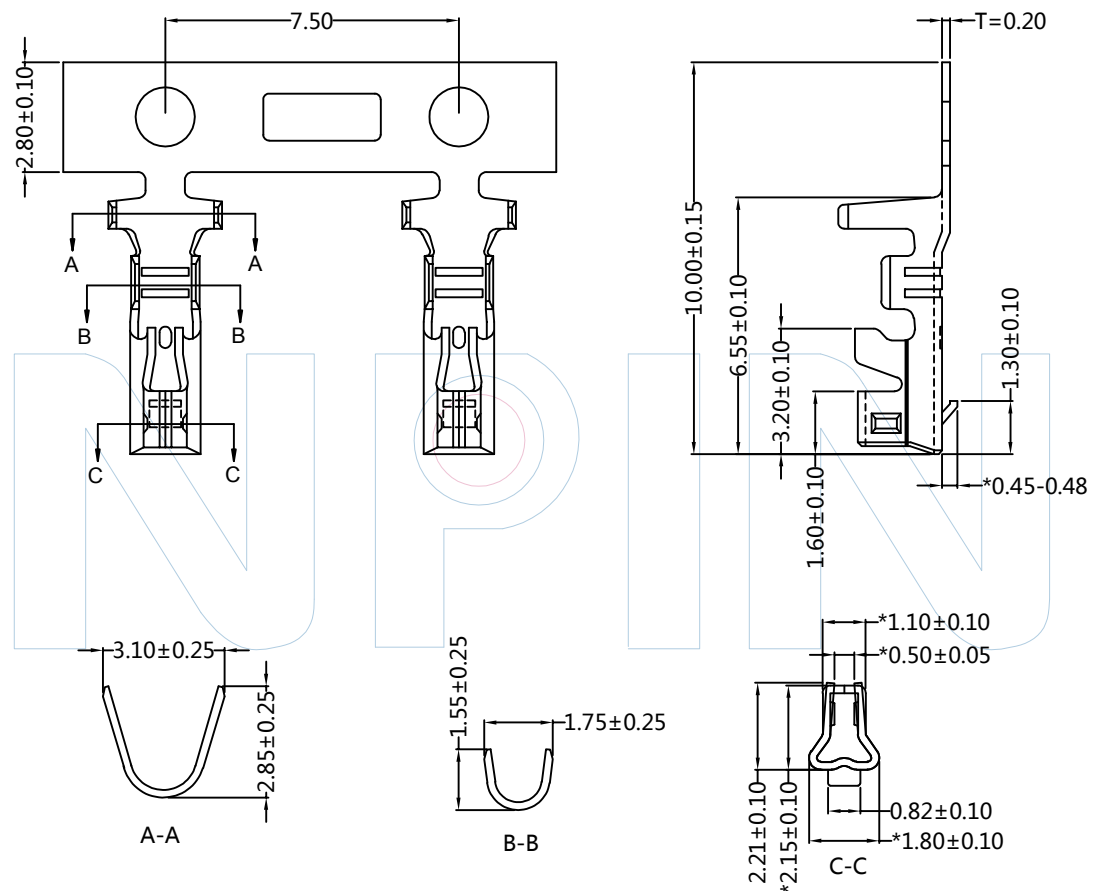
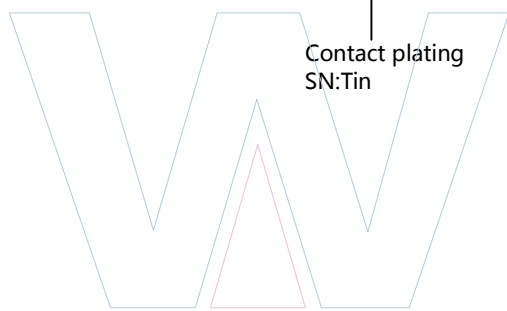

Tel: +86 769 82581808 FAX: +86 769 81766192
 E-Mail: sales@winpin.net Http: www.winpin.net

PART NO: T25022-PXX1

TITLE: XA 2.5mm Terminal

NOTE:
 Current Rating: 3.0A AC/DC
 Voltage Rating: 250V AC/DC
 Withstand Voltage: 1000V AC/Minute
 Contact Resistance: 10mΩ Max
 Applicable Wire: AWG#22-#26
 Mark *** as the key size

MATERIAL:
 Contact : Phosphor Bronze
 Contact Plating: Sn over Ni

UNLESS OTHERWISE SPECIFIED DIMENSIONS ARE IN METRIC TOLERANCES ARE:
 DECIMALS Angle
 X.X: ±0.40 ± 3°
 X.XX: ±0.25
 X.XXX: ±0.15

SCALE	1:1
UNIT	MM
PROJ.	
SHEET	

A0	2021/05/07	NEW	GF.He		Andy
REV	DATE	MODIFICATION DESCRIPTION	DRAW	CHANGE	APPROVE



RECOMMENDED P.C.B LAYOUT T=1.60mm
(TOLERANCE:±0.05mm)

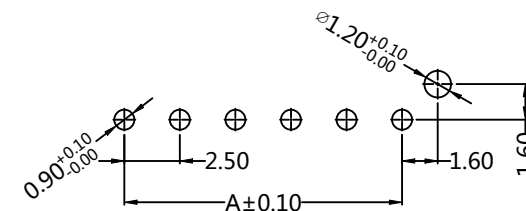

PART NUMBER CODING
W25022-1 XX S XX X X 1

No. of pins 02-15P Contact plating SN: Tin Color E= Beige Packing B= PE Bag

Pin No Type	1	2	3	4	5	6	N-2	N-1	N
	Poles								
6P Over	-	A	B	-	-	-	B	A	-
6P	-	A	B	B	A	-			
5P	A	B	-	B	A				
4P	A	B	B	A					
3P	A	B	A						
2P	A	B							

PINS	Dimensions(mm)			PINS	Dimensions(mm)		
	A	B	C		A	B	C
02	2.50	5.85	7.50	09	20.00	23.35	25.00
03	5.00	8.35	10.00	10	22.50	25.85	27.50
04	7.50	10.85	12.50	11	25.00	28.35	30.00
05	10.00	13.35	15.00	12	27.50	30.85	32.50
06	12.50	15.85	17.50	13	30.00	33.35	35.00
07	15.00	18.35	20.00	14	32.50	35.85	37.50
08	17.50	20.85	22.50	15	35.00	38.35	40.00

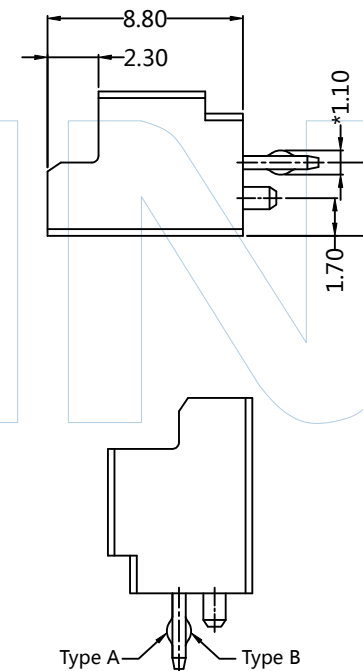
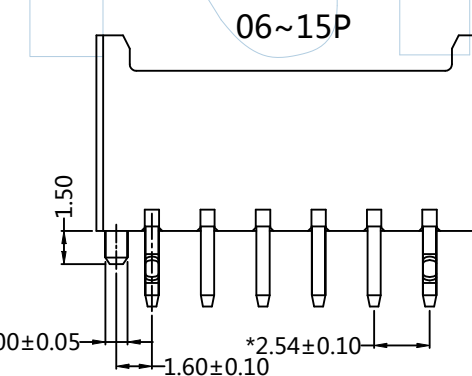
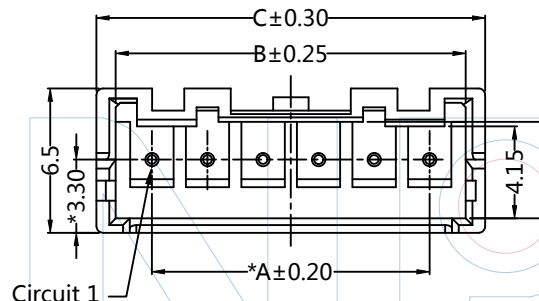
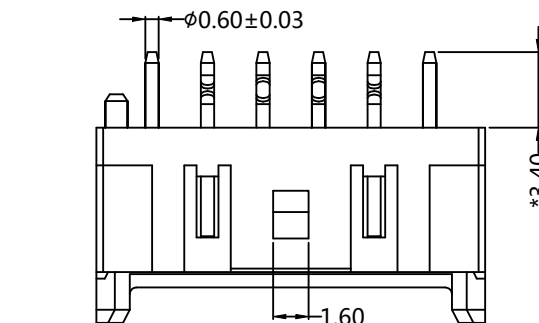

NOTE:
 Current Rating:3.0A AC/DC
 Voltage Rating:250V AC/DC
 Withstand Voltage:1000V AC/Minute
 Insulation Resistance: 1000MΩ Min
 Contact Resistance: 10mΩ Max
 Working Temperature: -40°C~+105°C
 Mark "*" as the key size

MATERIAL:
 Contact:Brass
 Contact Plating:Sn over Ni
 Insulator :PA66(UL94V-0)

UNLESS OTHERWISE SPECIFIED DIMENSIONS ARE IN METRIC
 TOLERANCES ARE:
 DECIMALS Angle
 X.X:±0.40 ± 3°
 X.XX:±0.25
 X.XXX:±0.15

WINPIN
 Tel: +86 769 82581808 FAX: +86 769 81766192
 E-Mail:sales@winpin.net Http://www.winpin.net

PART NO: W25022-1XXSXXXX1
 TITLE: XA2.5mm 180° Wafer

SCALE 1:1
 UNIT MM
 PROJ.
 SHEET

A0	2021/02/26	NEW	GF.He	Andy	
REV	DATE	MODIFICATION DESCRIPTIO	DRAW	CHANGE	APPROVE



PART NUMBER CODING
W25022-1 XX R XX X X 1

No. of pins: 02-15P
 Contact plating: SN: Tin
 Color: E=Beige
 Packing: B=PE Bag

RECOMMENDED P.C.B LAYOUT T=1.60mm
(TOLERANCE: ±0.05mm)

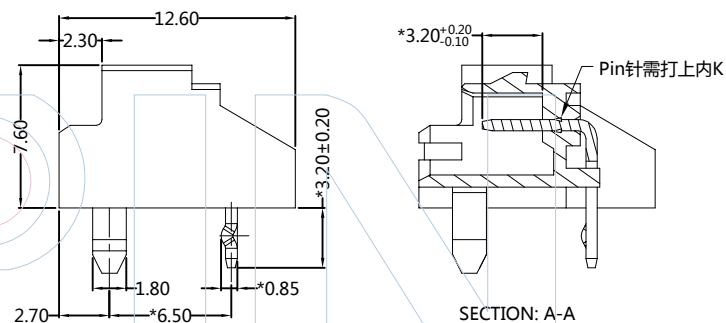
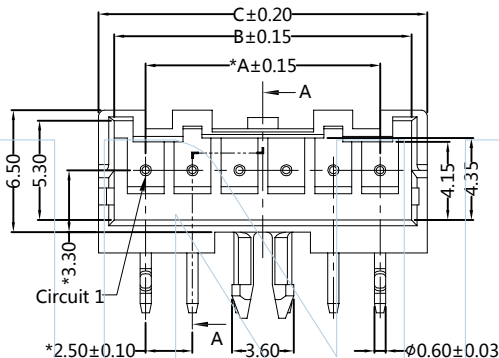
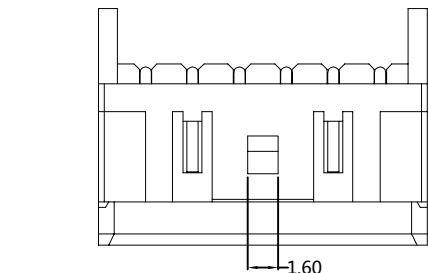
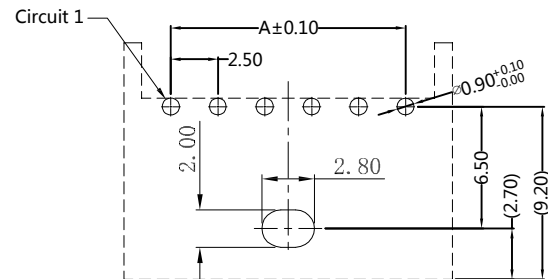

PINS	Dimensions(mm)		
	A	B	C
02	2.50	5.85	7.50
03	5.00	8.35	10.00
04	7.50	10.85	12.50
05	10.00	13.35	15.00
06	12.50	15.85	17.50
07	15.00	18.35	20.00
08	17.50	20.85	22.50
09	20.00	23.35	25.00
10	22.50	25.85	27.50
11	25.00	28.35	30.00
12	27.50	30.85	32.50
13	30.00	33.35	35.00
14	32.50	35.85	37.50
15	35.00	38.35	40.00

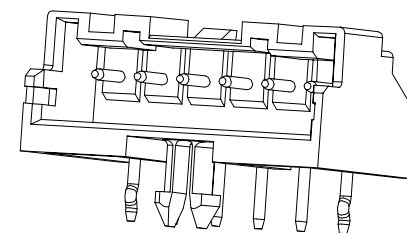
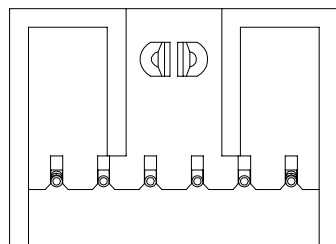

WINPIN
 Tel: +86 769 82581808 FAX: +86 769 81766192
 E-Mail: sales@winpin.net Http: www.winpin.net

PART NO: W25022-1XXRXXX1
 TITLE: 2.5mm 90° Wafer

NOTE:
 Current Rating: 3.0A AC/DC
 Voltage Rating: 250V AC/DC
 Withstand Voltage: 1000V AC/Minute
 Insulation Resistance: 1000MΩ Min
 Contact Resistance: 10mΩ Max
 Working Temperature: -40°C~+105°C
 Mark *** as the key size

MATERIAL:
 Contact: Brass
 Contact Plating: Sn over Ni
 Insulator: PA66(UL94V-0)

UNLESS OTHERWISE SPECIFIED DIMENSIONS ARE IN METRIC
 TOLERANCES ARE:
 DECIMALS Angle
 X.X: ±0.40 ± 3°
 X.XX: ±0.25
 X.XXX: ±0.15

SCALE: 1:1
 UNIT: MM
 PROJ.
 SHEET

A0	2021/02/26	NEW	GF.He	Andy	
REV	DATE	MODIFICATION DESCRIPTION	DRAW	CHANGE	APPROVE



Recommended P.C.B Layout(Top Side)
(PCB BOARD TOLERANCE±0.05)

PART NUMBER CODING
W25022-1 XX M XX X X 1

No. of pins 02-15P
Contact plating SN: Tin
Color E=Beige
Packing R=Reel+CAP

PINS	Dimensions(mm)		
	A	B	C
2	2.50	10.00	5.30
3	5.00	12.50	
4	7.50	15.00	
5	10.00	17.50	6.40
6	12.50	20.00	
7	15.00	22.50	
8	17.50	25.00	
9	20.00	27.50	
10	22.50	30.00	
11	25.00	32.50	
12	27.50	35.00	
13	30.00	37.50	
14	32.50	40.00	
15	35.00	42.50	

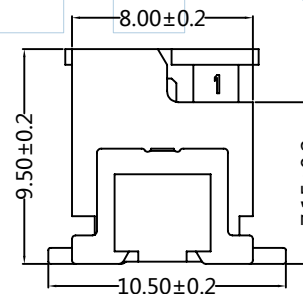
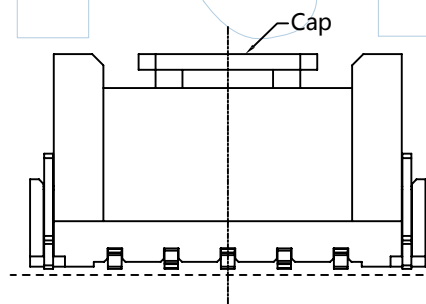
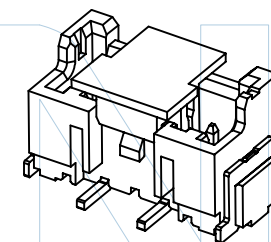
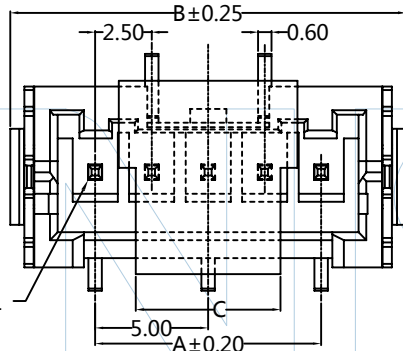
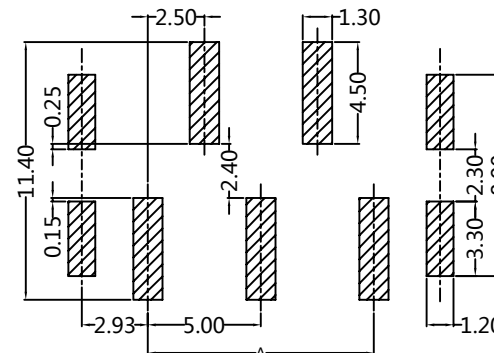
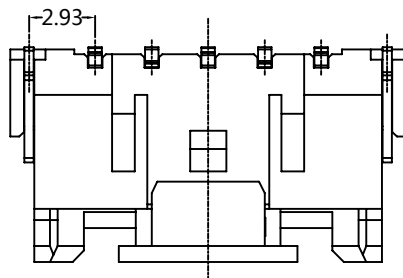

Tel: +86 769 82581808 FAX: +86 769 81766192
E-Mail: sales@winpin.net Http: www.winpin.net

NOTE:
Current Rating: 3.0A AC/DC
Voltage Rating: 250V AC/DC
Withstand Voltage: 1000V AC/Minute
Contact Resistance: 10mΩ Max
Insulation Resistance: 1000MΩ Min
Working Temperature: -25°C~+85°C

MATERIAL:
Contact :Brass
Contact Plating:Sn over Ni
Solder Tabs:Brass
Solder Tabs Plating:Sn over Ni
Insulator :PA9T(UL94V-0)

UNLESS OTHERWISE SPECIFIED DIMENSIONS ARE IN METRIC TOLERANCES ARE:
DECIMALS Angle
X.X:±0.40 ± 3°
X.XX:±0.25
X.XXX:±0.15

PART NO: W25022-1XXMXXXX1

TITLE: 2.5mm 180°SMT Wafer

SCALE 1:1
UNIT MM
PROJ.
SHEET

A0	2021/09/10	NEW	GF.He	Andy	
REV	DATE	MODIFICATION DESCRIPTIO	DRAW	CHANGE	APPROVE



Recommended P.C.B Layout(Top Side)
(PCB BOARD TOLERANCE±0.05)

PART NUMBER CODING
W25022-1 XX Z XX X X 1

No. of pins: 02-15P
 Contact plating: SN: Tin
 Color: E=Beige
 Packing: R=Reel

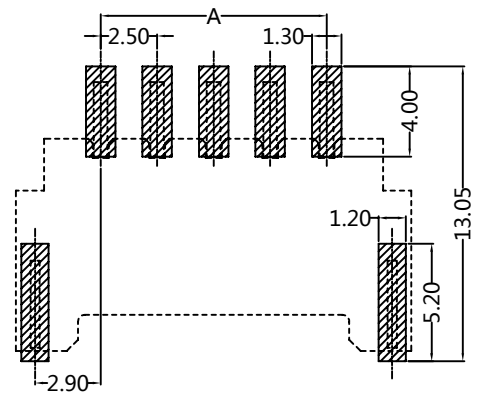
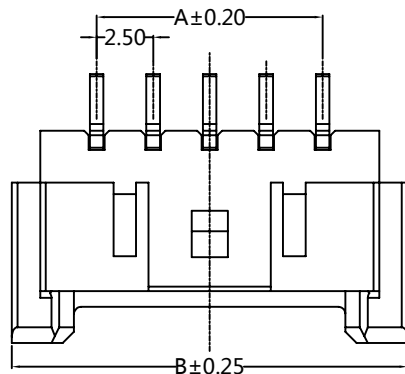

PINS	Dimensions(mm)			
	A	B	C	D
2	2.50	10.00	7.50	5.80
3	5.00	12.50	10.00	8.30
4	7.50	15.00	12.50	10.80
5	10.00	17.50	15.00	13.30
6	12.50	20.00	17.50	15.80
7	15.00	22.50	20.00	18.30
8	17.50	25.00	22.50	20.80
9	20.00	27.50	25.00	23.30
10	22.50	30.00	27.50	25.80
11	25.00	32.50	30.00	28.30
12	27.50	35.00	32.50	30.80
13	30.00	37.50	35.00	33.30
14	32.50	40.00	37.50	35.80
15	35.00	42.50	40.00	38.30

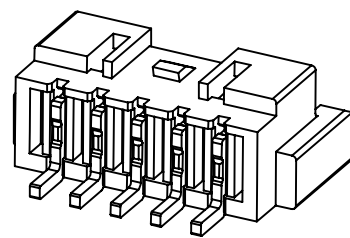
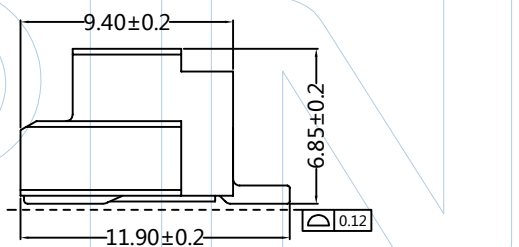
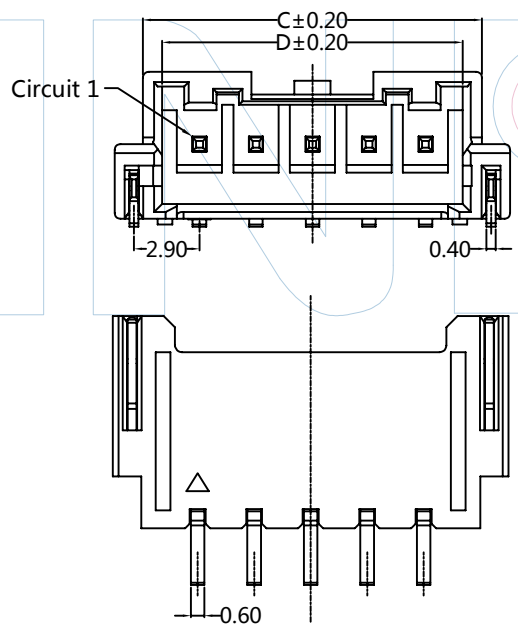

WINPIN
 Tel:+86 769 82581808 FAX:+86 769 81766192
 E-Mail:sales@winpin.net Http://www.winpin.net

PART NO: W25022-1XXZXXX1
 TITLE: 2.5mm 90°SMT Wafer

NOTE:
 Current Rating: 3.0A AC/DC
 Voltage Rating: 250V AC/DC
 Withstand Voltage: 1000V AC/Minute
 Contact Resistance: 10mΩ Max
 Insulation Resistance: 1000MΩ Min
 Working Temperature: -25°C~+85°C

MATERIAL:
 Contact :Brass
 Contact Plating:Sn over Ni
 Solder Tabs:Brass
 Solder Tabs Plating:Sn over Ni
 Insulator :PA9T(UL94V-0)

UNLESS OTHERWISE SPECIFIED DIMENSIONS ARE IN METRIC
 TOLERANCES ARE:
 DECIMALS Angle
 X.X:±0.40 ± 3°
 X.XX:±0.25
 X.XXX:±0.15

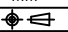
SCALE 1:1
 UNIT MM
 PROJ. 
 SHEET

A0	2021/09/10	NEW	GF.He	Andy	
REV	DATE	MODIFICATION DESCRIPTIO	DRAW	CHANGE	APPROVE