



PART NUMBER CODING

H30001-2 XX X X

No. of pins
02-12P

Color
B=Black

Series No
7=UL94V-2
8=UL94V-0

Pins	Dimensions	
	A	B
2*01	—	3.85
2*02	3.00	6.85
2*03	6.00	9.85
2*04	9.00	12.85
2*05	12.00	15.85
2*06	15.00	18.85
2*07	18.00	21.85
2*08	21.00	24.85
2*09	24.00	27.85
2*10	27.00	30.85
2*11	30.00	33.85
2*12	33.00	36.85

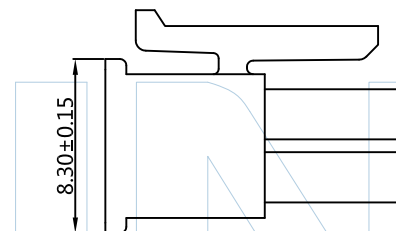
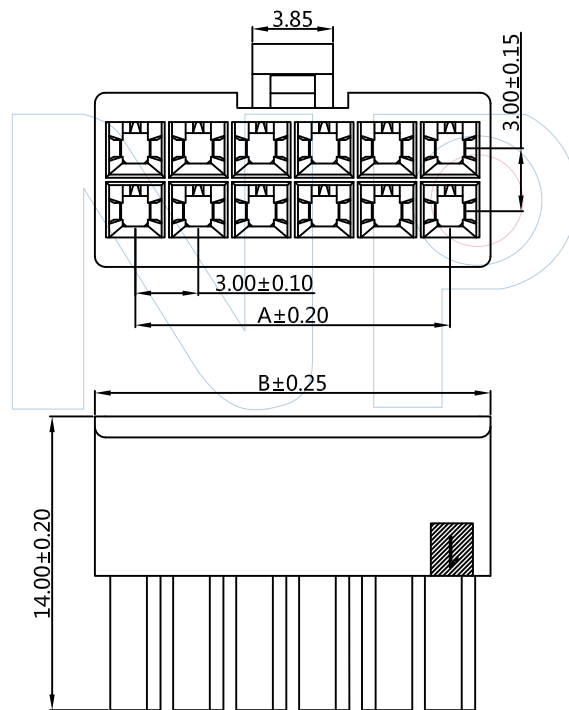
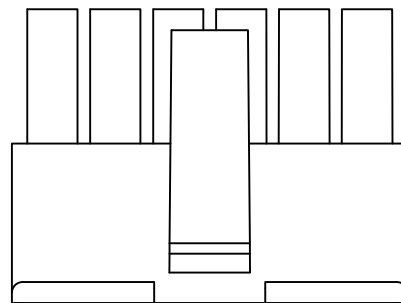

8.30±0.15

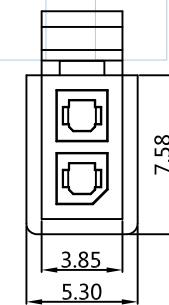

2x1P

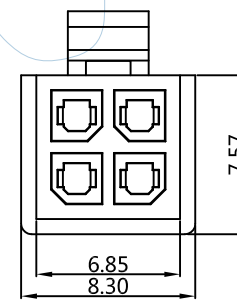

2x2P



Tel: +86 769 82581808 FAX: +86 769 81766192
E-Mail: sales@winpin.net Http: www.winpin.net

PART NO: H30001-2XXXX

TITLE: MX3.0mm Housing

NOTES:
Current Rating: 5.0AMP
Voltage Rating: 250V AC, DC
Withstand Voltage: 1500V AC/Minute
Contact Resistance: 10mΩ Max
Insulation Resistance: 1000MΩ Min
Operation Temperature: -40°C to +105°C

Insulator Material:
PA66 (UL94-V2/UL94-V0)

UNLESS OTHERWISE SPECIFIED DIMENSIONS ARE IN METRIC TOLERANCES ARE:
DECIMALS Angle
X.X: ±0.40 ± 3°
X.XX: ±0.25
X.XXX: ±0.15

SCALE	1:1
UNIT	MM
PROJ.	
SHEET	1/2

A0	2018/06/25	NEW	GF.He	Andy	Bobby
REV	DATE	MODIFICATION DESCRIPTION	DRAW	CHANGE	APPROVE

PART NUMBER CODING
T30001-P XX 3

Contact plating
SN: Tin

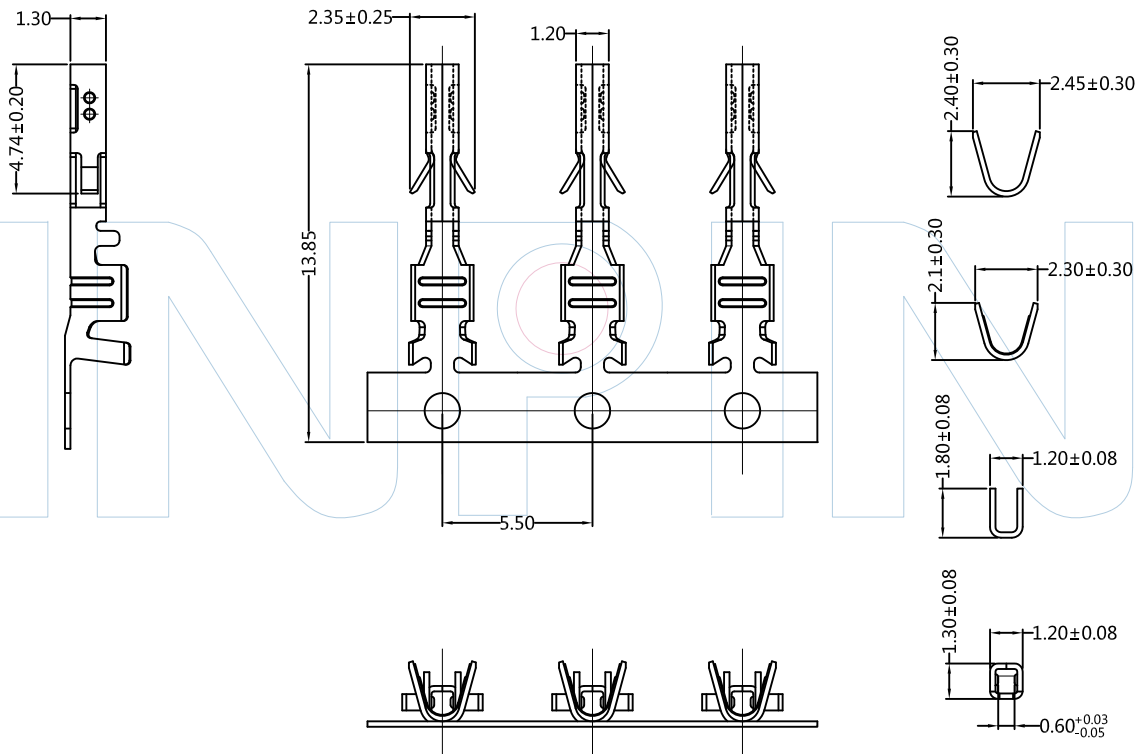

Tel: +86 769 82581808 FAX: +86 769 81766192
E-Mail: sales@winpin.net Http: www.winpin.net

PART NO: T30001-PXX3

TITLE: MX3.0mm Female Terminal

NOTES:

Current Rating: 5.0AMP
Voltage Rating: 250V AC, DC
Withstand Voltage: 1500V AC/Minute
Contact Resistance: 10mΩ Max
Insulation Resistance: 1000MΩ Min
Operation Temperature: -40°C ~ +105°C
Applicable Wire: 22-26 AWG

MATERIAL:

Contant : Phosphor Bronze
Contant Plating: Sn over Ni

UNLESS OTHERWISE SPECIFIED DIMENSIONS ARE IN METRIC

TOLERANCES ARE:
DECIMALS Angle
X.X: ± 0.40 ± 3°
X.XX: ± 0.25
X.XXX: ± 0.15

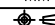
SCALE 1:1
UNIT MM
PROJ. 
SHEET

A0	2015/06/25	NEW	GF.He		Andy
REV	DATE	MODIFICATION DESCRIPTION	DRAW	CHANGE	APPROVE

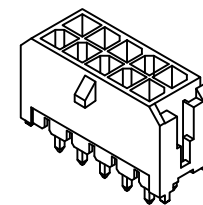
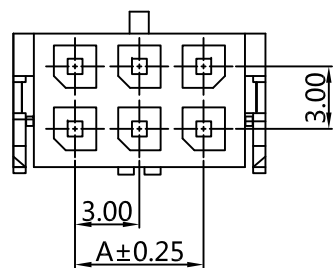

PART NUMBER CODING
W30001-2 XX S XX X X 1

No. of pins: 01P-12P
 Contact plating: SN: Tin
 Color: B: Black
 Packing: A: Tray, B: PE Bag

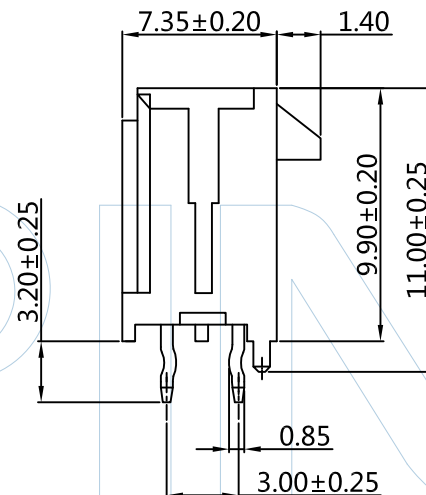
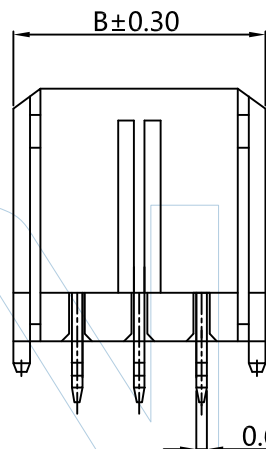

Pins	Dimensions	
	A	B
2*1	--	6.65
2*2	3.00	9.65
2*3	6.00	12.65
2*4	9.00	15.65
2*5	12.00	18.65
2*6	15.00	21.65
2*7	18.00	24.65
2*8	21.00	27.65
2*9	24.00	30.65
2*10	27.00	33.65
2*11	30.00	36.65
2*12	33.00	39.65

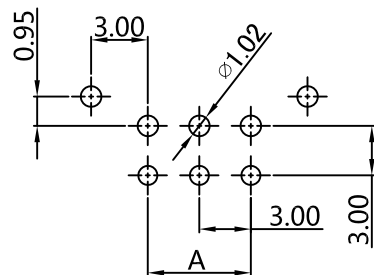

P.C.B LAYOUT

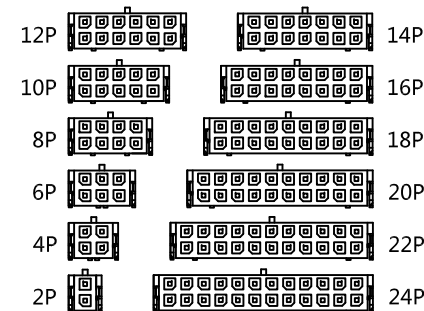

Tel: +86 769 82581808 FAX: +86 769 81766192
 E-Mail: sales@winpin.net Http: www.winpin.net

PART NO: W30001-2XXSXXX1

TITLE: MX 3.00mm wafer Dual ROW 180° dip With post

NOTES:
 Current Rating: 5.0AMP
 Voltage Rating: 250V AC, DC
 Withstand Voltage: 1500V AC/Minute
 Contact Resistance: 10mΩ Max
 Insulation Resistance: 1000MΩ Min
 Operation Temperature: -40°C to +105°C
 Applicable Terminal: T30001-PXX2-1
 Applicable Housing: H30001-2XXXX-1

Material:
 Contact Material: Brass
 Contact Plating: Au or Sn over Ni
 Insulator Material: PA46 (UL94V-0)

UNLESS OTHERWISE SPECIFIED DIMENSIONS ARE IN METRIC TOLERANCES ARE:
 DECIMALS Angle
 X.X: ±0.40 ± 3°
 X.XX: ±0.25
 X.XXX: ±0.15

SCALE	1:1
UNIT	MM
PROJ.	
SHEET	1/2

A0	2018/06/25	NEW	Jason.Huang		Jason.Huang
REV	DATE	MODIFICATION DESCRIPTION	DRAW	CHANGE	APPROVE

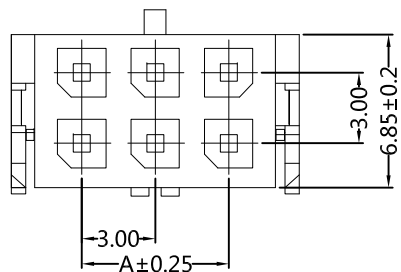
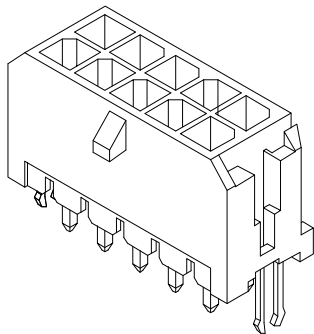

Recommended P.C.B Layout(Top Side)
(PCB BOARD TOLERANCE±0.05)

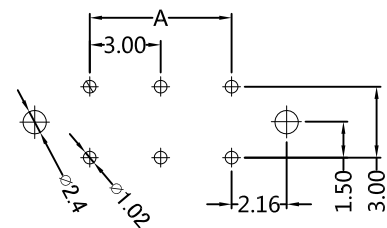

PART NUMBER CODING

W30001-2 XX S XX X X 2

No. of pins: 01P-12P
Contact plating: SN: Tin
Color: B=Black
Packing: A: Tray, B: PE Bag

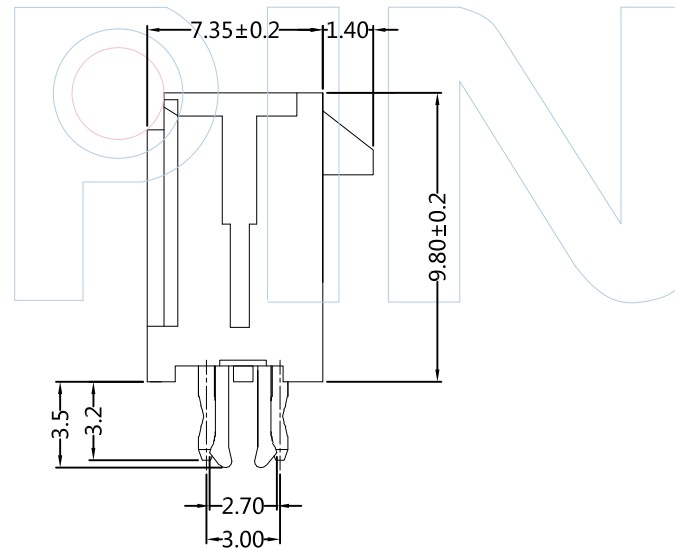
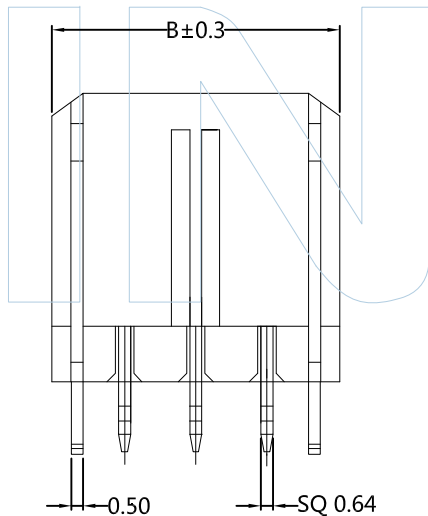

Pins	Dimensions	
	A	B
2*1	--	6.65
2*2	3.00	9.65
2*3	6.00	12.65
2*4	9.00	15.65
2*5	12.00	18.65
2*6	15.00	21.65
2*7	18.00	24.65
2*8	21.00	27.65
2*9	24.00	30.65
2*10	27.00	33.65
2*11	30.00	36.65
2*12	33.00	39.65



Tel: +86 769 82581808 FAX: +86 769 81766192
E-Mail: sales@winpin.net Http: www.winpin.net

PART NO: W30001-2XXSXXXX2

TITLE: 3.00mm wafer Dual ROW 180°DIP With CLIP

NOTES:
Current Rating: 5.0AMP
Withstand Voltage: 250V AC/DC
Withstand Voltage: 1500V AC/Minute
Contact Resistance: 10mΩ Max
Insulation Resistance: 1000MΩ Min
Operation Temperature: -40°C to +105°C
Applicable Terminal: T30001-PXX2-1
Applicable Housing: H30001-2XXXX-1

Material:
Contact Material: Brass
Contact Plating: Au or Sn over Ni
Insulator Material: LCP(UL94V-0)

UNLESS OTHERWISE SPECIFIED DIMENSIONS ARE IN METRIC TOLERANCES ARE:

DECIMALS Angle
X.X: ±0.40 ± 3°
X.XX: ±0.25
X.XXX: ±0.15

SCALE 1:1
UNIT MM
PROJ.
SHEET

A0	2020/06/25	NEW	Jason.Huang		Jason.Huang
REV	DATE	MODIFICATION DESCRIPTION	DRAW	CHANGE	APPROVE

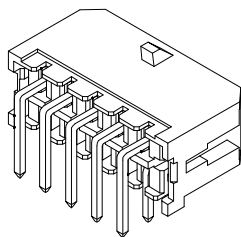

PART NUMBER CODING

W30001-2 XX R XX X X 1

No. of pins
01P-12P

Contact plating
SN: Tin

Color
B: Black

Packing
A: Tray
B: PE Bag

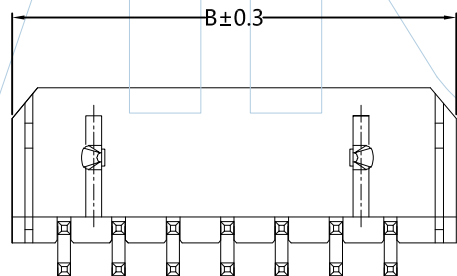
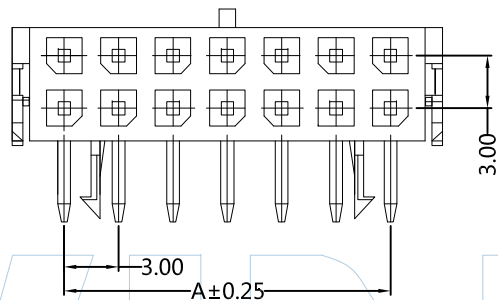

Recommended P.C.B Layout(Top Side)
(PCB BOARD TOLERANCE±0.05)

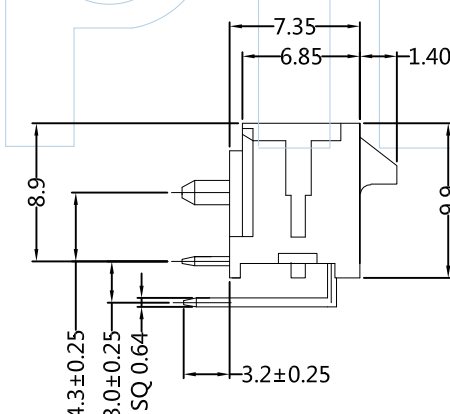
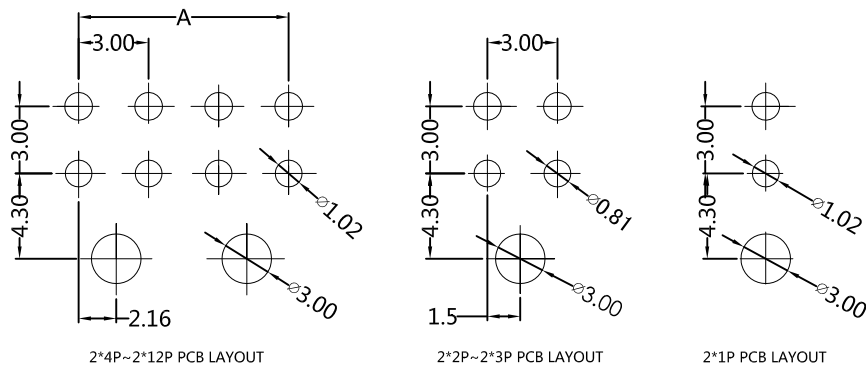

Pins	Dimensions	
	A	B
2*1	--	6.65
2*2	3.00	9.65
2*3	6.00	12.65
2*4	9.00	15.65
2*5	12.00	18.65
2*6	15.00	21.65
2*7	18.00	24.65
2*8	21.00	27.65
2*9	24.00	30.65
2*10	27.00	33.65
2*11	30.00	36.65
2*12	33.00	39.65



Tel: +86 769 82581808 FAX: +86 769 81766192
E-Mail: sales@winpin.net Http: www.winpin.net

PART NO: W30001-2XXRXXXX1

TITLE: MX3.00mm Wafer Dual ROW 90°DIP With post

NOTES:
Current Rating: 5.0AMP
Voltage Rating: 250V AC, DC
Withstand Voltage: 1500V AC/Minute
Contact Resistance: 10mΩ Max
Insulation Resistance: 1000MΩ Min
Operation Temperature: -40°C to +105°C
Applicable Terminal: T30001-PXX2-1
Applicable Housing: H30001-2XXXX-1

Material:
Contact Material: Brass
Contact Plating: Au or Sn over Ni
Insulator Material: PA46 (UL94V-0)

UNLESS OTHERWISE SPECIFIED DIMENSIONS ARE IN METRIC TOLERANCES ARE:
DECIMALS Angle
X.X: ±0.40 ± 3°
X.XX: ±0.25
X.XXX: ±0.15

SCALE	1:1
UNIT	MM
PROJ.	
SHEET	1/2

A0	2015/06/25	NEW	Jason.Huang	Jason.Huang	
REV	DATE	MODIFICATION DESCRIPTION	DRAW	CHANGE	APPROVE



Recommended P.C.B Layout(Top Side)
(PCB BOARD TOLERANCE±0.05)

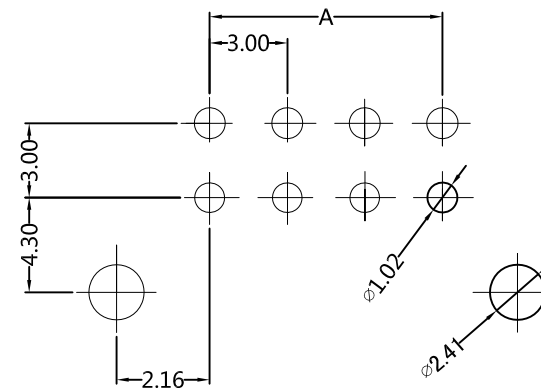
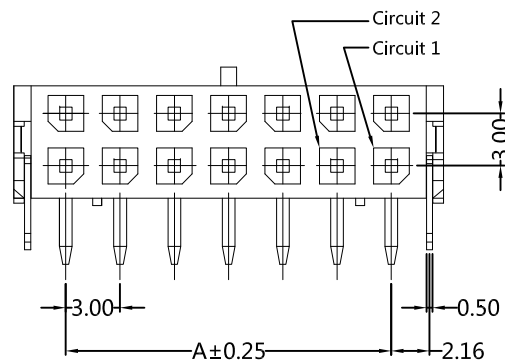

PART NUMBER CODING
W30001-2 XX R XX X X 2

No. of pins
01P-12P

Contact plating
SN: Tin

Color
B=Black

Packing
A: Tray
B: PE Bag

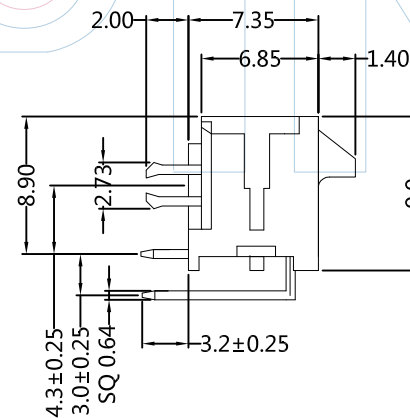
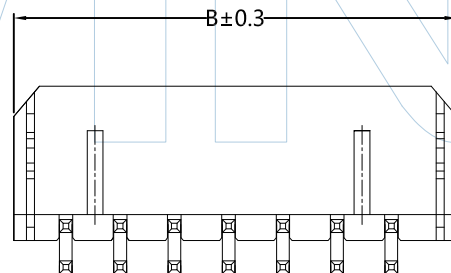

Pins	Dimensions	
	A	B
2*1	--	6.65
2*2	3.00	9.65
2*3	6.00	12.65
2*4	9.00	15.65
2*5	12.00	18.65
2*6	15.00	21.65
2*7	18.00	24.65
2*8	21.00	27.65
2*9	24.00	30.65
2*10	27.00	33.65
2*11	30.00	36.65
2*12	33.00	39.65

Tel: +86 769 82581808 FAX: +86 769 81766192
E-Mail: sales@winpin.net Http: www.winpin.net

PART NO: W30001-2XXRXXXX2
TITLE: 3.00mm wafer Row 90°DIP With Clip

NOTES:
Current Rating:5.0AMP
Voltage Rating:250V AC,DC
Withstand Voltage:1500V AC/Minute
Contact Resistance:10mΩ Max
Insulation Resistance:1000MΩ Min
Operation Temperature:-40°C to +105°C
Applicable Terminal:T30001-PXX2-1
Applicable Housing:H30001-2XXXX-1

Material:
Contact Material:Brass
Contact Plating: Au or Sn over Ni
Insulator Material:LCP (UL94V-0)

UNLESS OTHERWISE SPECIFIED DIMENSIONS ARE IN METRIC TOLERANCES ARE:
DECIMALS Angle
X.X:±0.40 ± 3°
X.XX:±0.25
X.XXX:±0.15
SCALE 1:1
UNIT MM
PROJ.
SHEET

A0	2021/04/20	NEW	Andy	Andy	
REV	DATE	MODIFICATION DESCRIPTION	DRAW	CHANGE	APPROVE

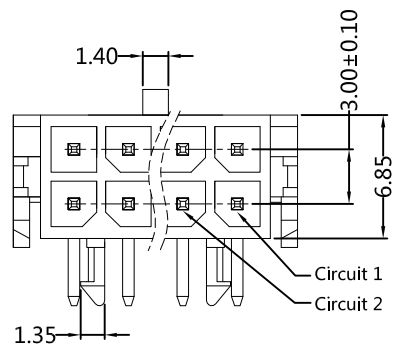
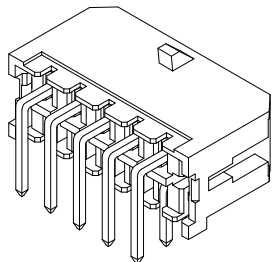

PART NUMBER CODING
W30001-2 XX R XX X X 3

No. of pins
01P-12P

Contact plating
SN: Tin

Color
B: Black

Packing
A: Tray
B: PE Bag

Pins	Dimensions	
	A	B
2*1	--	6.65
2*2	3.00	9.65
2*3	6.00	12.65
2*4	9.00	15.65
2*5	12.00	18.65
2*6	15.00	21.65
2*7	18.00	24.65
2*8	21.00	27.65
2*9	24.00	30.65
2*10	27.00	33.65
2*11	30.00	36.65
2*12	33.00	39.65

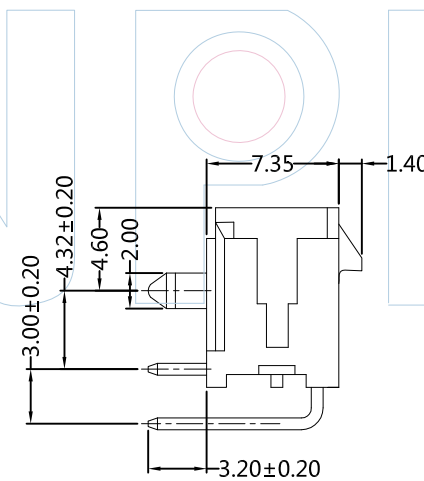
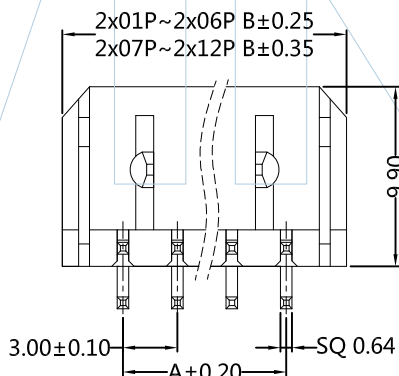

Recommended P.C.B Layout(Top Side)
(PCB BOARD TOLERANCE±0.05)

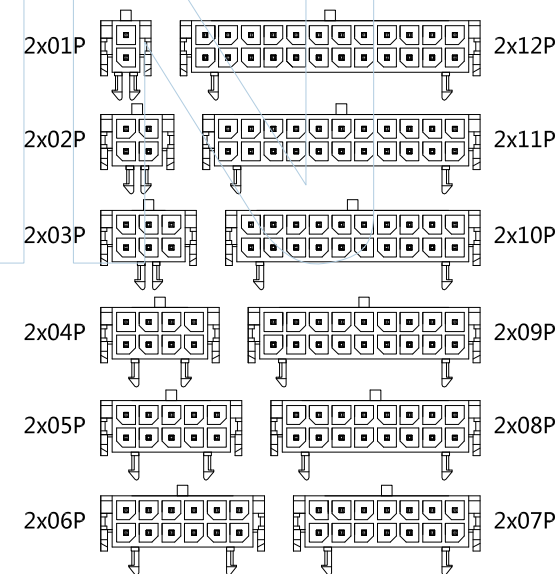
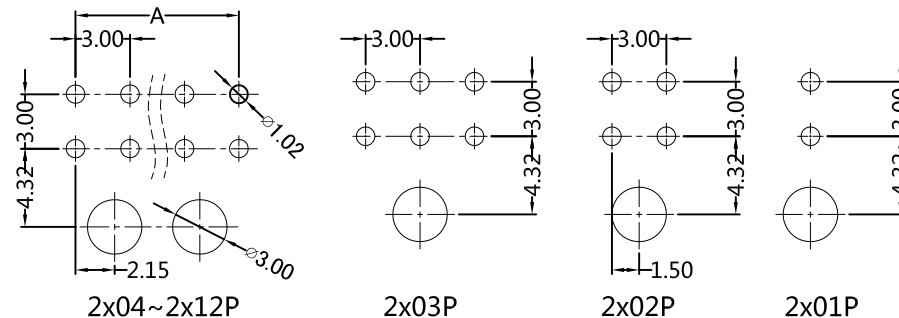

CIRCUIT SIZE LAYOUT



Tel: +86 769 82581808 FAX: +86 769 81766192
E-Mail: sales@winpin.net Http: www.winpin.net

PART NO: W30001-2XXRXXX3

TITLE: MX3.00mm wafer dual ROW 90°DIP With post

NOTES:
Current Rating:5.0AMP
Voltage Rating:250V AC,DC
Withstand Voltage:1500V AC/Minute
Contact Resistance:20mΩ Max
Insulation Resistance:1000MΩ Min
Operation Temperature:-25°C to +85°C
Applicable Terminal:T30001-PXX2-1
Applicable Housing:H30001-2XXXX-1

Material:
Contact Material:Brass
Contact Plating:Au or Sn over Ni
Insulator Material:PA66+15%GF (UL94V-0)

UNLESS OTHERWISE SPECIFIED DIMENSIONS ARE IN METRIC TOLERANCES ARE:
DECIMALS Angle
X.X:±0.40 ± 3°
X.XX:±0.25
X.XXX:±0.15

SCALE	1:1
UNIT	MM
PROJ.	
SHEET	1/2

A0	2015/06/25	NEW	Jason.Huang	Jason.Huang	
REV	DATE	MODIFICATION DESCRIPTION	DRAW	CHANGE	APPROVE



Recommended P.C.B Layout(Top Side)
(PCB BOARD TOLERANCE±0.05)

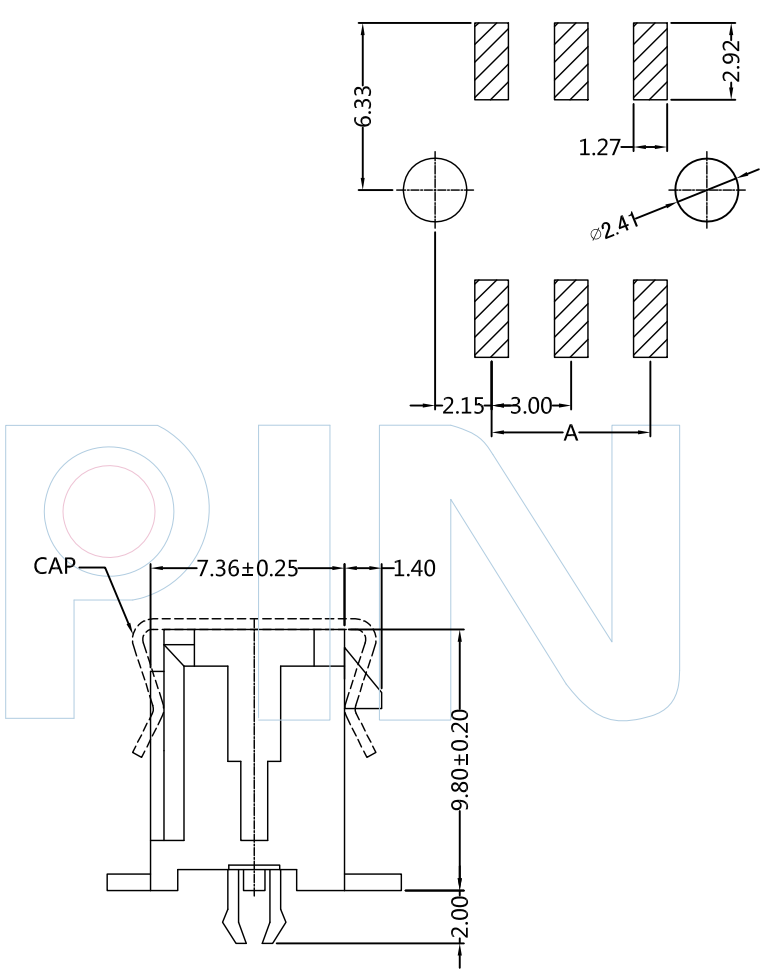
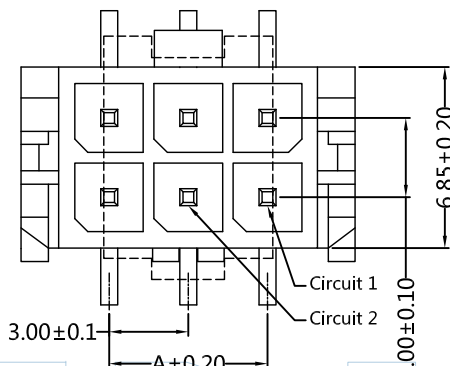

PART NUMBER CODING
W30001-2 XX M XX X X 1

No. of pins
01P-12P

Contact plating
SN: Tin

Color
B=Black

Packing
R=Tape&Reel

Pins	Dimensions	
	A	B
2*1	--	6.65
2*2	3.00	9.65
2*3	6.00	12.65
2*4	9.00	15.65
2*5	12.00	18.65
2*6	15.00	21.65
2*7	18.00	24.65
2*8	21.00	27.65
2*9	24.00	30.65
2*10	27.00	33.65
2*11	30.00	36.65
2*12	33.00	39.65



Tel: +86 769 82581808 FAX: +86 769 81766192
E-Mail: sales@winpin.net Http: www.winpin.net

PART NO: W30001-2XXMXXX1

TITLE: 3.00mm wafer DUAL ROW 180°SMT With CLIP

NOTES:

Current Rating: 5.0AMP
Withstand Voltage: 250V AC/DC
Contact Resistance: 10mΩ Max
Insulation Resistance: 1000MΩ Min
Operation Temperature: -25°C to +85°C
Applicable Terminal: T30001-PXX2-1
Applicable Housing: H30001-2XXXX-1

Material:

Contact Material: Phosphor Bronze or Brass
Contact Plating: Au or Sn over Ni
Insulator Material: LCP(UL94V-0)

UNLESS OTHERWISE SPECIFIED DIMENSIONS ARE IN METRIC TOLERANCES ARE:

DECIMALS Angle
X.X: ±0.40 ± 3°
X.XX: ±0.25
X.XXX: ±0.15

SCALE	1:1
UNIT	MM
PROJ.	
SHEET	

A0	2015/06/25	NEW	Hua.ZT		Hua.ZT
REV	DATE	MODIFICATION DESCRIPTION	DRAW	CHANGE	APPROVE

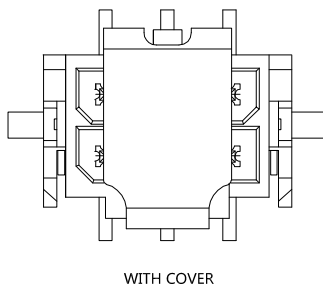
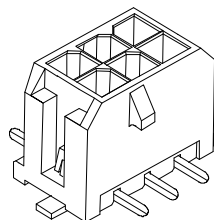

WITH COVER

Recommended P.C.B Layout(Top Side)
(PCB BOARD TOLERANCE±0.05)

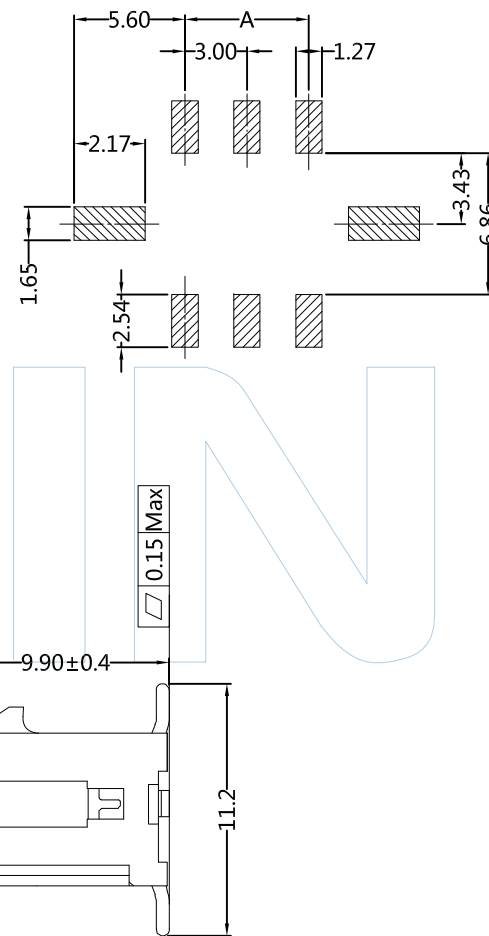

PART NUMBER CODING

W30001-2 XX M XX X X 2

No.of pins
01P-12P

Contact plating
SN:tin

Color
B=Black

Packing
R=Tape&Reel

Pins	Dimensions	
	A	B
2*1	--	6.65
2*2	3.00	9.65
2*3	6.00	12.65
2*4	9.00	15.65
2*5	12.00	18.65
2*6	15.00	21.65
2*7	18.00	24.65
2*8	21.00	27.65
2*9	24.00	30.65
2*10	27.00	33.65
2*11	30.00	36.65
2*12	33.00	39.65

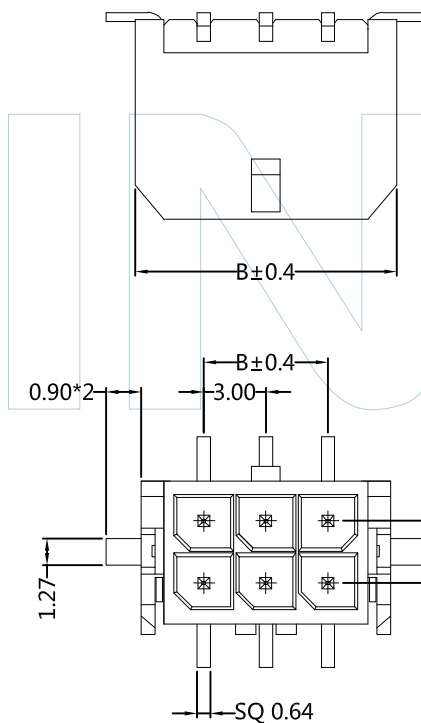

Tel:+86 769 82581808
E-Mail:sales@winpin.net

FAX:+86 769 81766192
Http:www.winpin.net

PART NO: W30001-2XXMXXXX2

TITLE: 3.00mm wafer DUAL ROW 180°SMT

NOTES:
Current Rating:5.0AMP
Voltage Rating:250V AC,DC
Withstand Voltage:1500V AC/Minute
Contact Resistance:10mΩ Max
Insulation Resistance:1000MΩ Min
Operation Temperature:-40°C to +105°C
Applicable Terminal:T30001-PXX2-1
Applicable Housing:H30001-2XXXX-1

Material:
Contact Material:Brass
Solder Nail:Brass
Contact Plating:Au over Ni
Solder Nail Plating:Sn over Ni
Insulator Material:LCP (UL94V-0)

UNLESS OTHERWISE SPECIFIED DIMENSIONS ARE IN METRIC TOLERANCES ARE:
DECIMALS Angle
X.X:±0.40 ± 3°
X.XX:±0.25
X.XXX:±0.15

SCALE	1:1
UNIT	MM
PROJ.	
SHEET	

A0	2015/06/25	NEW	ChaoLong,Yuan	ChaoLong,Yuan	
REV	DATE	MODIFICATION DESCRIPTIO	DRAW	CHANGE	APPROVE

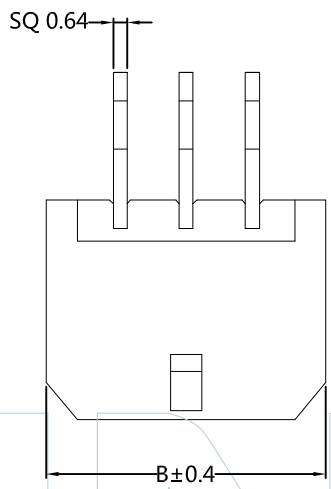
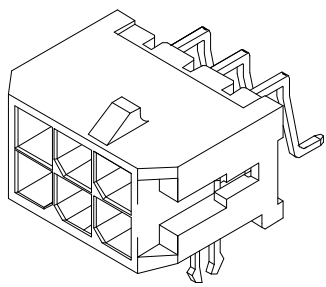

Recommended P.C.B Layout(Top Side)
(PCB BOARD TOLERANCE±0.05)

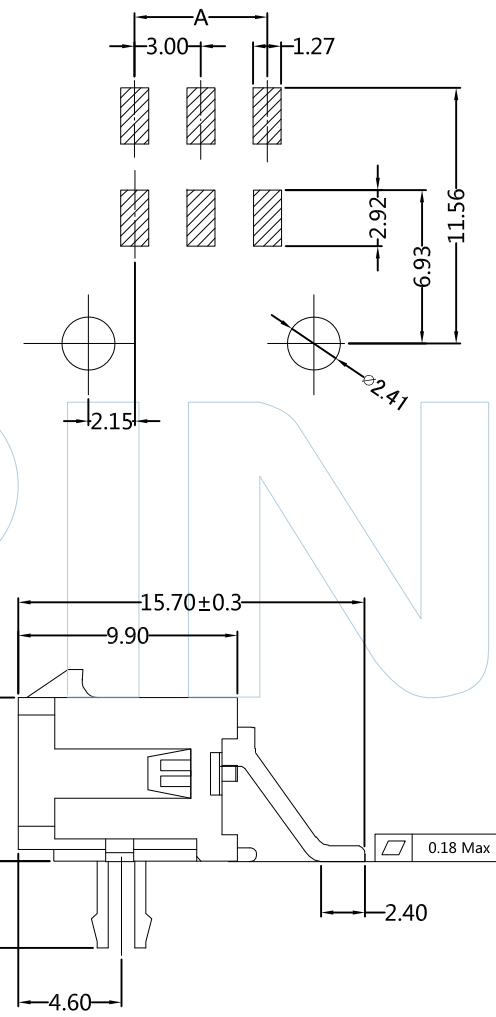

PART NUMBER CODING
W30001-2 XX Z XX X X 2

No.of pins 01P-12P Contact plating SN: Tin Color B=Black Packing R=Tape&Reel

Pins	Dimensions	
	A	B
2*1	--	6.65
2*2	3.00	9.65
2*3	6.00	12.65
2*4	9.00	15.65
2*5	12.00	18.65
2*6	15.00	21.65
2*7	18.00	24.65
2*8	21.00	27.65
2*9	24.00	30.65
2*10	27.00	33.65
2*11	30.00	36.65
2*12	33.00	39.65

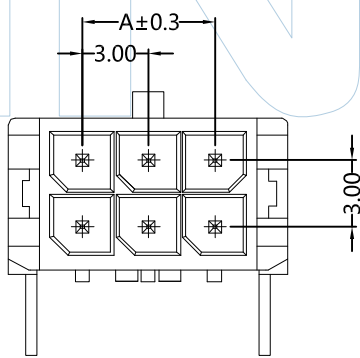

WINPIN
 Tel:+86 769 82581808 FAX:+86 769 81766192
 E-Mail:sales@winpin.net Http:www.winpin.net

PART NO: W30001-2XXZXXX2
 TITLE: 3.00mm wafer Dual ROW 90°SMT With clip

NOTES:
 Current Rating:5.0AMP
 Withstand Voltage:250V AC/DC
 Withstand Voltage:1500V AC/Minute
 Contact Resistance:10mΩ Max
 Insulation Resistance:1000MΩ Min
 Operation Temperature:-40°C to +105°C
 Applicable Terminal:T30001-PXX2-1
 Applicable Housing:H30001-2XXXX-1

Material:
 Contact Material: Brass
 Contact Plating:Au or Sn over Ni
 Insulator Material:LCP(UL94V-0)

UNLESS OTHERWISE SPECIFIED DIMENSIONS ARE IN METRIC TOLERANCES ARE:
 DECIMALS Angle
 X.X:±0.40 ± 3°
 X.XX:±0.25
 X.XXX:±0.15
 SCALE 1:1
 UNIT MM
 PROJ.
 SHEET

A0	2020/06/25	NEW	Jason.Huang	Jason.Huang	
REV	DATE	MODIFICATION DESCRIPTION	DRAW	CHANGE	APPROVE



Recommended P.C.B Layout(Top Side)
(PCB BOARD TOLERANCE±0.05)

PART NUMBER CODING
W30001-2 XX Z XX X X 3

No.of pins
02P-24P

Contact plating
G0:Gold Flash
G1:3U*Gold
G2:5U*Gold
G3:10U*Gold
G4:15U*Gold
G5:20U*Gold
G6:30U*Gold
S0:Gold Flash/Tin
S1:3U*Gold/Tin
S2:5U*Gold/Tin
S3:10U*Gold/Tin
S4:15U*Gold/Tin
S6:30U*Gold/Tin
SN:Tin

Color
W=White
B=Black
E=Beige

Packing
B=PE Bag
T=Tube
R=Tape&Reel

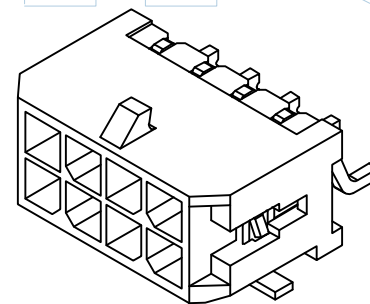
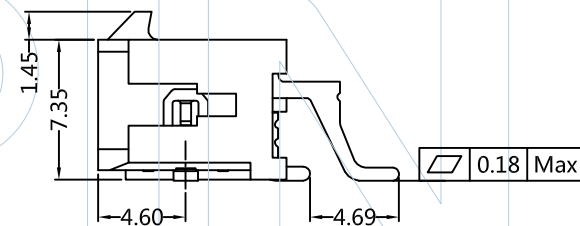
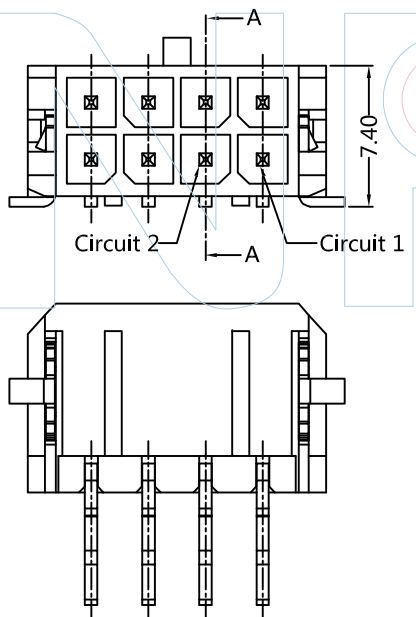
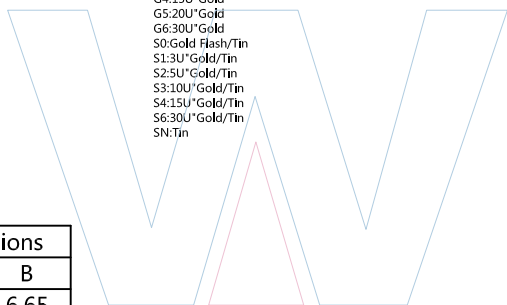
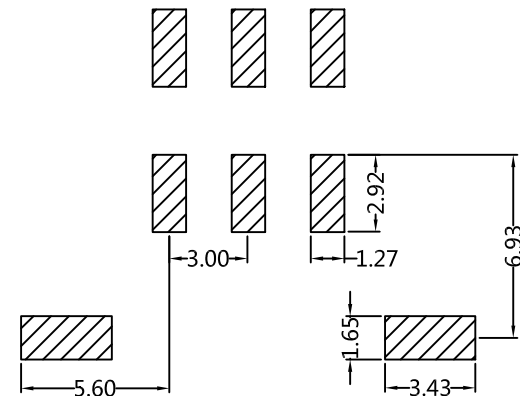
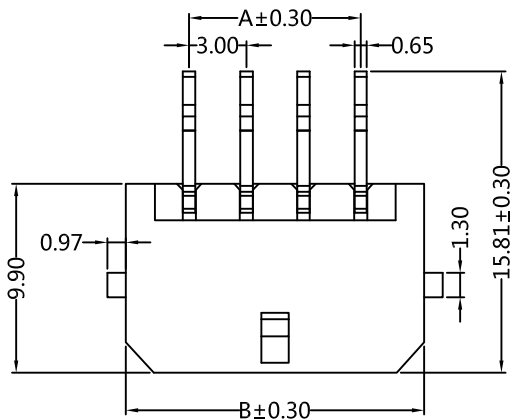

Pins	Dimensions	
	A	B
2x02	--	6.65
2x04	3.00	9.65
2x06	6.00	12.65
2x08	9.00	15.65
2x10	12.00	18.65
2x12	15.00	21.65
2x14	18.00	24.65
2x16	21.00	27.65
2x18	24.00	30.65
2x20	27.00	33.65
2x22	30.00	36.65
2x24	33.00	39.65



Tel:+86 769 82581808 FAX:+86 769 81766192
E-Mail:sales@winpin.net Http://www.winpin.net

PART NO: W30001-2XXZXXXX3

TITLE: 3.00mm Wafer Dual ROW 90°Smt With Latch

NOTES:
Current Rating:5.0AMP
Withstand Voltage:250V AC/DC
Withstand Voltage:1500V AC/Minute
Contact Resistance:10mΩ Max
Insulation Resistance:1000MΩ Min
Operation Temperature:-40°C to +105°C
Applicable Terminal:T30001-PXX2-1
Applicable Housing:H30001-2XXXX

MATERIAL:
Contact Material: Brass
Solder nail: Brass
Plating:Au or Sn over Ni
Insulator Material:LCP(UL94V-0)

UNLESS OTHERWISE SPECIFIED DIMENSIONS ARE IN METRIC
TOLERANCES ARE:
DECIMALS Angle
X.X:±0.40 ± 3°
X.XX:±0.25
X.XXX:±0.15

SCALE	1:1
UNIT	MM
PROJ.	
SHEET	

A0	2015/06/25	NEW	Hua.ZT		Hua.ZT
REV	DATE	MODIFICATION DESCRIPTIO	DRAW	CHANGE	APPROVE