



PART NUMBER CODING

H39603-1 XX X 1

No. of pins
02-15P

Color
E=Beige
W=White

Pins	Dimensions	
	A	B
02	3.96	8.25
03	7.92	12.21
04	11.88	16.17
05	15.84	20.13
06	19.80	24.09
07	23.76	28.05
08	27.72	32.01
09	31.68	35.97
10	35.64	39.93
11	39.60	43.89
12	43.56	47.85
13	47.52	51.81
14	51.48	55.77
15	55.44	59.73

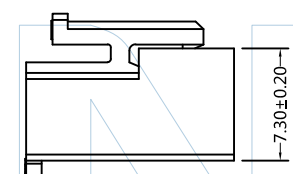
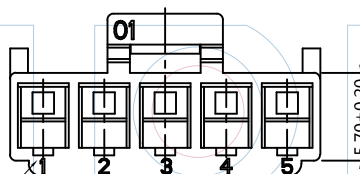
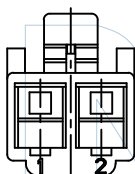
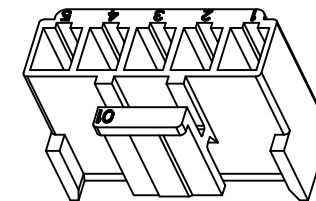
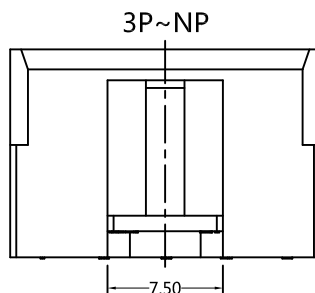
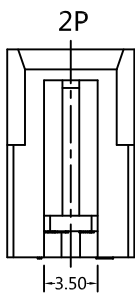

Circuit 1

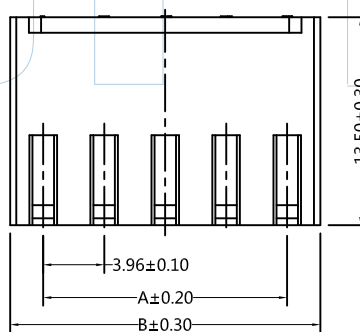

Tel: +86 769 82581808 FAX: +86 769 81766192
E-Mail: sales@winpin.net Http: www.winpin.net

PART NO: H39603-1XXX1

TITLE: VH 3.96mm Housing

NOTES:
Current Rating:7.0A AC/DC
Voltage Rating:250V AC/DC
Withstand Voltage:1500V AC/DC
Contact Resistance:20mΩ Max
Insulation Resistance:1000MΩ Min
Operation Temperature:-25°C~ +85°C
Applicable Terminal:T39603-PXX1
Applicable Wafer:W39603-1XXXXXX1

MATERIAL:
Insulator:PA66, UL94V-0

UNLESS OTHERWISE SPECIFIED DIMENSIONS ARE IN METRIC TOLERANCES ARE:
DECIMALS Angle
X.X:±0.40 ± 3°
X.XX:±0.25
X.XXX:±0.15

SCALE	1:1
UNIT	MM
PROJ.	
SHEET	

A0	2015/06/25	NEW	GF.He	Andy	
REV	DATE	MODIFICATION DESCRIPTION	DRAW	CHANGE	APPROVE



PART NUMBER CODING
T39603-P XX 1

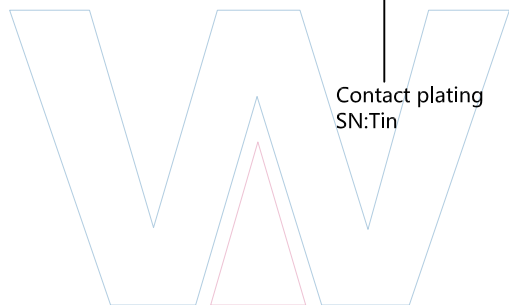

Contact plating
 SN: Tin

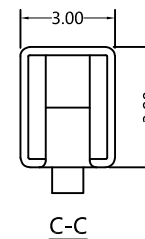
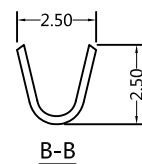
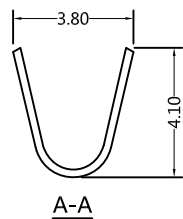
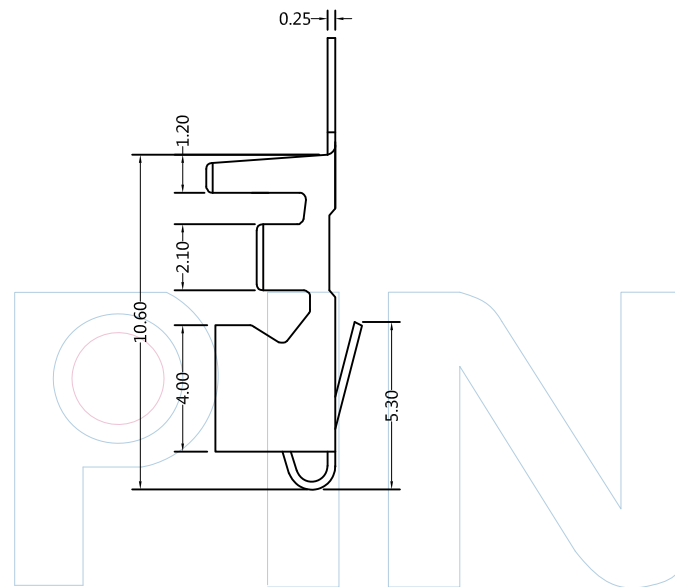
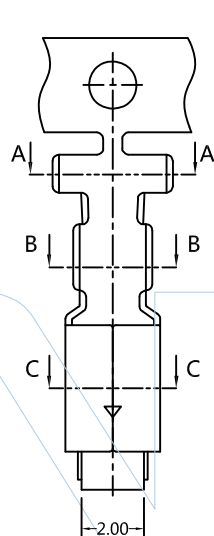

Tel: +86 769 82581808 FAX: +86 769 81766192
 E-Mail: sales@winpin.net Http: www.winpin.net

PART NO: T39603-PXX1

TITLE: VH 3.96mm Terminal

NOTES:
 Current Rating: 7.0A AC/DC
 Voltage Rating: 250V AC/DC
 Withstand Voltage: 1500V AC/DC
 Contact Resistance: 20mΩ Max
 Insulation Resistance: 1000MΩ Min
 Operation Temperature: -25°C ~ +85°C
 Applicable Wire: AWG#18-#22
 Applicable Terminal: T39603-PXX1
 Applicable Wafer: W39603-1XXXXXX1

MATERIAL:
 Contact: Phosphor Bronze
 Contact Plating: Sn over Ni

UNLESS OTHERWISE SPECIFIED DIMENSIONS ARE IN METRIC
 TOLERANCES ARE:
 DECIMALS Angle
 X.X: ±0.40 ± 3°
 X.XX: ±0.25
 X.XXX: ±0.15

SCALE	1:1
UNIT	MM
PROJ.	
SHEET	

A0	2015/06/25	NEW	Hua.ZT		Hua.ZT
REV	DATE	MODIFICATION DESCRIPTIO	DRAW	CHANGE	APPROVE



Recommended P.C.B Layout(Top Side)
(PCB BOARD TOLERANCE±0.05)

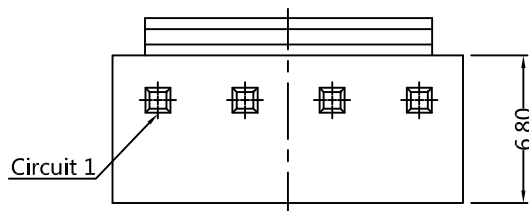
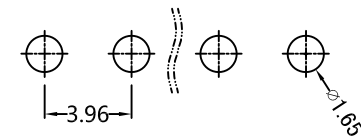

PART NUMBER CODING

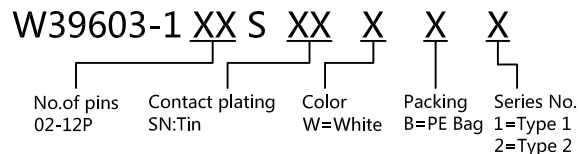

Pins	Dimensions	
	A	B
02	3.96	8.02
03	7.92	11.98
04	11.88	15.94
05	15.84	19.90
06	19.80	23.86
07	23.76	27.82
08	27.72	31.78
09	31.68	35.74
10	35.64	39.70
11	39.60	43.66
12	43.56	47.62

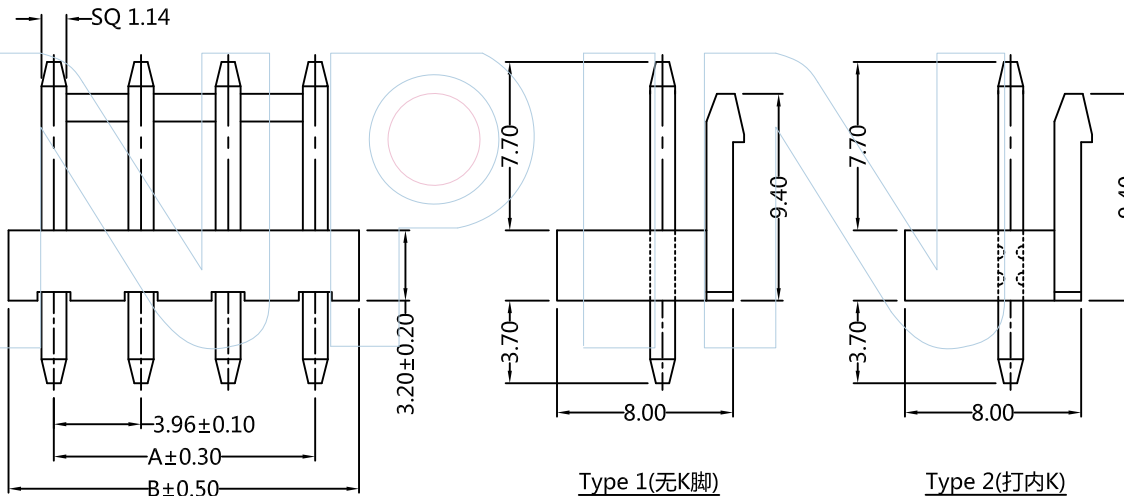

WINPIN

Tel: +86 769 82581808 FAX: +86 769 81766192
E-Mail: sales@winpin.net Http: www.winpin.net

PART NO: W39603-1XXSXXXX
TITLE: VH3.96mm Wafer XXP 有靠背180° PA66

NOTES:
Current Rating:7.0AMP
Voltage Rating:250V AC/DC
Withstand Voltage:1500V AC/DC
Contact Resistance:10mΩ Max
Insulation Resistance:1000MΩ Min
Operation Temperature:-25°C to +85°C
Applicable Terminal:T39603-PXX1
Applicable Housing:H39603-1XXX1

MATERIAL:
Contact:Brass
Contact Plating:Sn over Ni
Insulator:PA66, UL94-V0

UNLESS OTHERWISE SPECIFIED DIMENSIONS ARE IN METRIC
TOLERANCES ARE:
DECIMALS Angle
X.X:±0.40 ± 3°
X.XX:±0.25
X.XXX:±0.15

SCALE 1:1
UNIT MM
PROJ.
SHEET

A0	2020/06/25	NEW	Jason.Huang		Jason.Huang
REV	DATE	MODIFICATION DESCRIPTION	DRAW	CHECKED	APPROVE



4P~15P

2P~3P

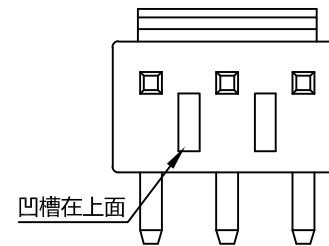
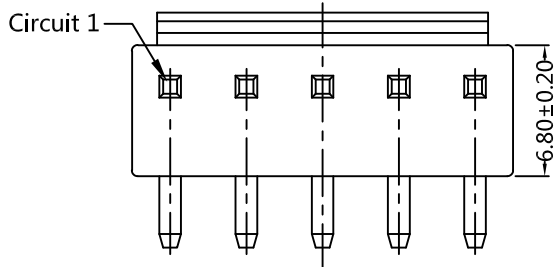

PART NUMBER CODING
W39603-1 XX R XX X X 1

No. of pins: 02-15P
Contact plating: SN: Tin
Color: W: White
Packing: B: PE Bag

Pins	Dimensions	
	A	B
02	3.96	7.92
03	7.92	11.88
04	11.88	15.84
05	15.84	19.80
06	19.80	23.76
07	23.76	27.72
08	27.72	31.68
09	31.68	35.64
10	35.64	39.60
11	39.60	43.56
12	43.56	47.52
13	47.52	51.48
14	51.48	55.44
15	55.44	59.40

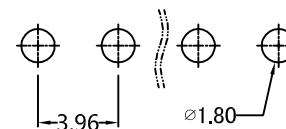
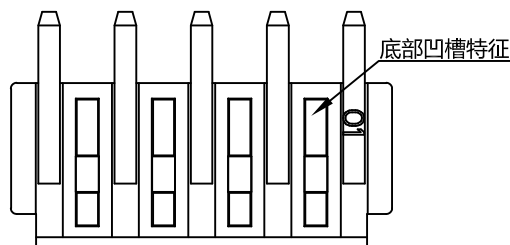
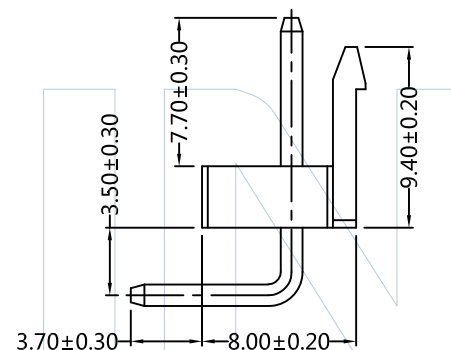
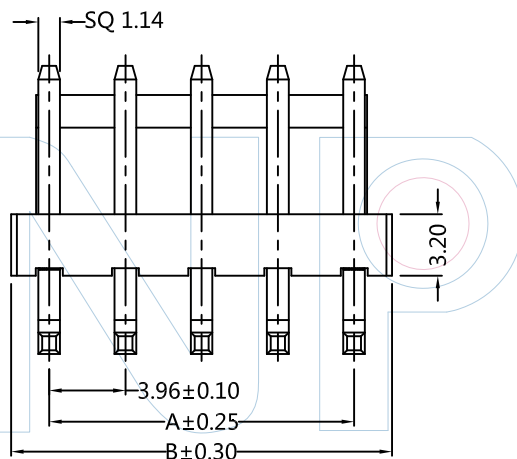
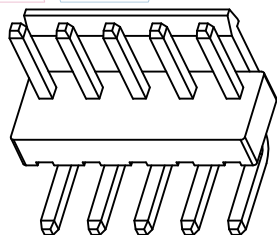

Recommended P.C.B Layout (Top Side)
(PCB BOARD TOLERANCE ±0.05)



Tel: +86 769 82581808 FAX: +86 769 81766192
E-Mail: sales@winpin.net Http: www.winpin.net

PART NO: W39603-1XXRXXX1

TITLE: VH 3.96mm 90° Wafer 有靠背

NOTES:
Current Rating: 7.0A AC/DC
Voltage Rating: 250V AC/DC
Withstand Voltage: 1500V AC/DC
Contact Resistance: 20mΩ Max
Insulation Resistance: 1000MΩ Min
Operation Temperature: -25°C ~ +85°C
Applicable Terminal: T39603-PXX1
Applicable Housing: H39603-1XXX1

MATERIAL:
Contact: Brass
Contact Plating: Sn over Ni
Insulator: PA66, UL94V-0

UNLESS OTHERWISE SPECIFIED DIMENSIONS ARE IN METRIC
TOLERANCES ARE:
DECIMALS Angle
X.X: ±0.40 ± 3°
X.XX: ±0.25
X.XXX: ±0.15

SCALE 1:1
UNIT MM
PROJ.
SHEET

A0	2015/06/25	NEW	GF.He	Andy	
REV	DATE	MODIFICATION DESCRIPTION	DRAW	CHANGE	APPROVE

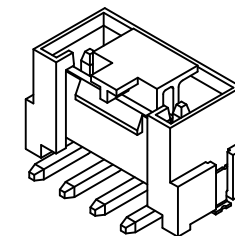
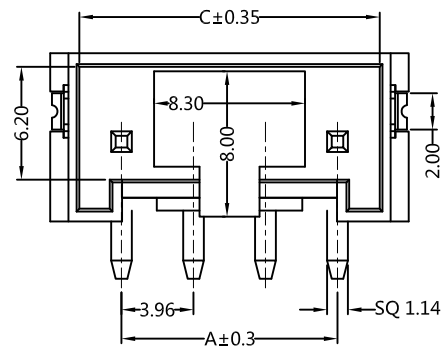

PART NUMBER CODING

W39603-1 XX M XX X X 1

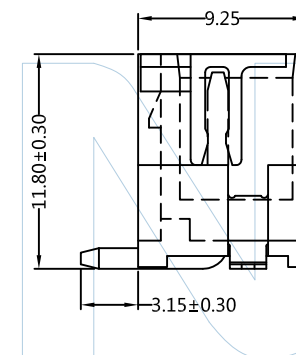
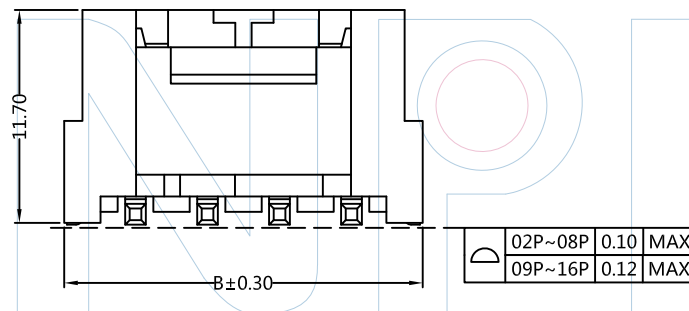
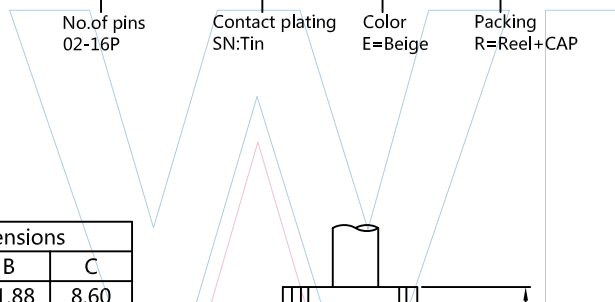

Pins	Dimensions		
	A	B	C
02	3.96	11.88	8.60
03	7.92	15.84	12.56
04	11.88	19.80	16.52
05	15.84	23.76	20.48
06	19.80	27.72	24.44
07	23.76	31.68	28.40
08	27.72	35.64	32.36
09	31.68	39.60	36.32
10	35.64	43.56	40.28
11	39.60	47.52	44.24
12	43.56	51.48	48.20
13	47.52	55.44	52.16
14	51.48	59.40	56.12
15	55.44	63.36	60.08
16	59.40	67.32	64.04

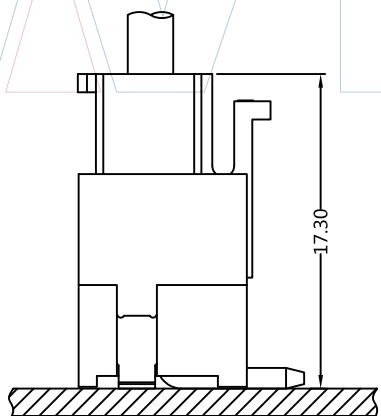

Assembly Layout

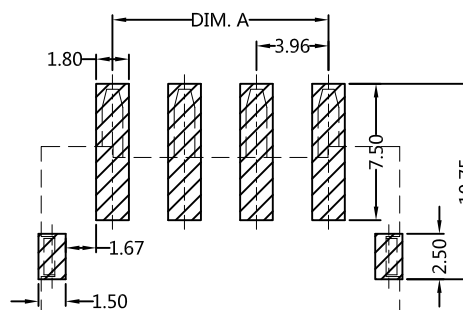

Recommended P.C.B Layout(Top Side)
(PCB BOARD TOLERANCE±0.05)

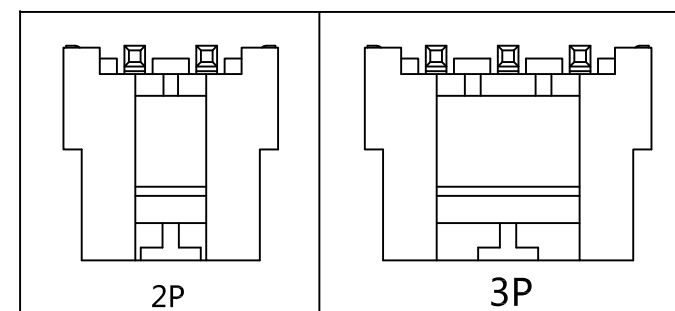

Tel: +86 769 82581808 FAX: +86 769 81766192
E-Mail: sales@winpin.net Http: www.winpin.net

NOTES:
Current Rating:7.0A AC/DC
Voltage Rating:250V AC/DC
Withstand Voltage:1000V AC/DC
Contact Resistance:20mΩ Max
Insulation Resistance:1500MΩ Min
Operation Temperature:-25℃~+105℃
Applicable Terminal:T39603-PXX1
Applicable Housing:H39603-1XXX1

MATERIAL:
Contact:Brass
Contact Plating:Sn over Ni
Solde tabs:Phosphor Bronze
Solde tabs Plating:Sn over Ni
Insulator:PA9T, UL94V-0
Cap:PA9T,UL94V-0,Natural

UNLESS OTHERWISE SPECIFIED DIMENSIONS ARE IN METRIC
TOLERANCES ARE:
DECIMALS Angle
X.X:±0.40 ± 3°
X.XX:±0.25
X.XXX:±0.15

PART NO: W39603-1XXMXXXX1

TITLE: VH 3.96mm Wafer 180° SMT

SCALE 1:1
UNIT MM
PROJ.
SHEET 1/2

A0	2016/05/12	NEW	Hua.ZT		Hua.ZT
REV	DATE	MODIFICATION DESCRIPTIO	DRAW	CHANGE	APPROVE



PART NUMBER CODING

W39603-1 XX Z XX X X 1

No. of pins: 02-08P
 Contact plating: SN: Tin
 Color: E=Beige
 Packing: R: Reel

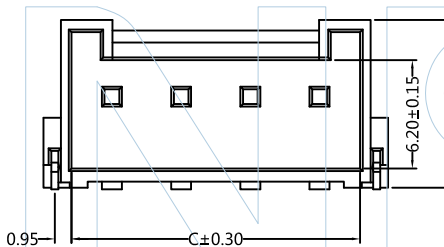
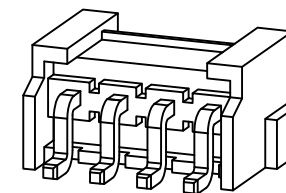
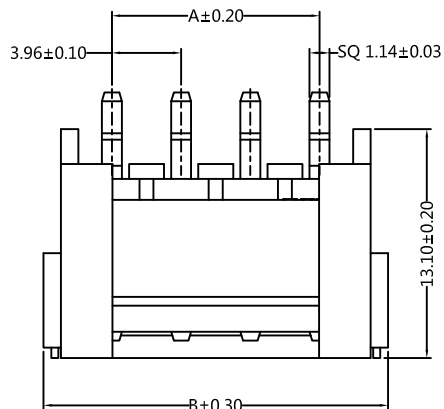

D	02P~08P	0.10	MAX
	09P~16P	0.12	MAX

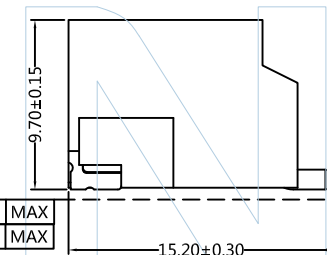

Pins	Dimensions		
	A	B	C
02	3.96	11.88	8.60
03	7.92	15.84	12.56
04	11.88	19.80	16.52
05	15.84	23.76	20.48
06	19.80	27.72	24.44
07	23.76	31.68	28.40
08	27.72	35.64	32.36

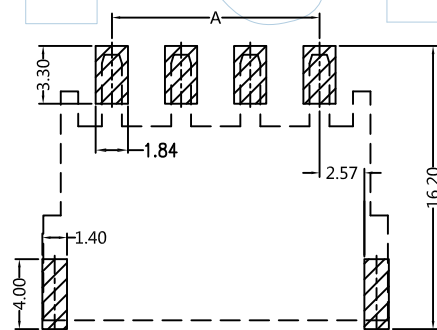

Recommended P.C.B Layout(Top Side)
 (PCB BOARD TOLERANCE±0.05)

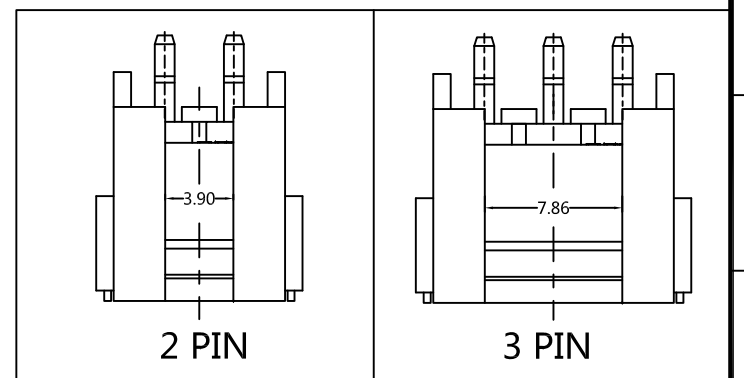

WINPIN
 Tel: +86 769 82581808 FAX: +86 769 81766192
 E-Mail: sales@winpin.net Http: www.winpin.net

PART NO: W39603-1XXZXXXX1
 TITLE: VH3.96mm Wafer 90° SMT

NOTES:
 Current Rating:7.0A AC/DC
 Voltage Rating:250V AC/DC
 Withstand Voltage:1000V AC/DC
 Contact Resistance:20mΩ Max
 Insulation Resistance:1500MΩ Min
 Operation Temperature:-25°C ~ +105°C
 Applicable Terminal:T39603-PXX1
 Applicable Housing:H39603-1XXX1

MATERIAL:
 Contact:Brass
 Contact Plating:Sn over Ni
 Solde tabs:Brass
 Solde tabs Plating:Sn over Ni
 Insulator:PA9T, UL94V-0

UNLESS OTHERWISE SPECIFIED DIMENSIONS ARE IN METRIC
 TOLERANCES ARE:
 DECIMALS Angle
 X.X:±0.40 ± 3°
 X.XX:±0.25
 X.XXX:±0.15

SCALE 1:1
 UNIT MM
 PROJ.
 SHEET

A0	2020/05/12	NEW	Jason.Huang	Jason.Huang
REV	DATE	MODIFICATION DESCRIPTIO	DRAW	CHANGE
				APPROVE