



PART NUMBER CODING

H50801-1 XX X 1

No. of pins
02~12P

Color
W=White

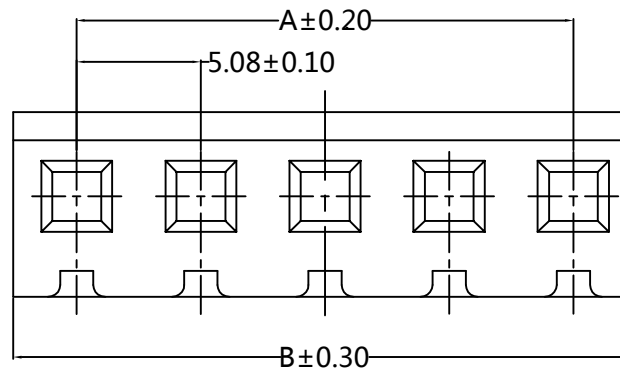

Poles	Dimensions	
	A	B
02P	5.08	10.16
03P	10.16	15.24
04P	15.24	20.32
05P	20.32	25.40
06P	25.40	30.48
07P	30.48	35.56
08P	35.56	40.64
09P	40.64	45.64
10P	45.64	50.80
11P	50.80	55.88
12P	55.88	60.96

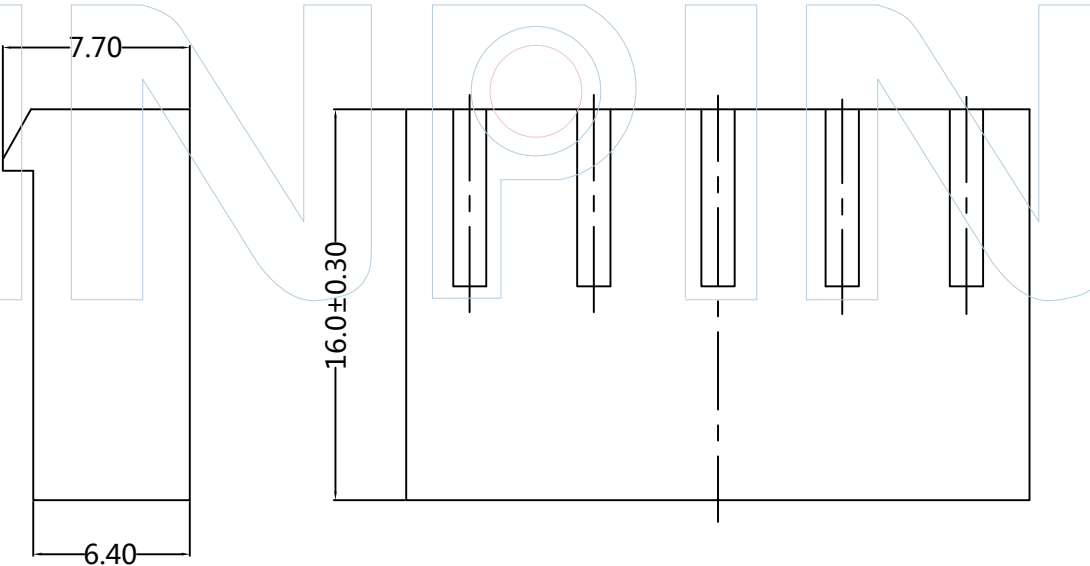

Tel: +86 769 82581808 FAX: +86 769 81766192
E-Mail: sales@winpin.net Http: www.winpin.net

PART NO: H50801-1XXX1

TITLE: 5.08mm HOUSING

NOTES:
Current Rating:5.0AMP
Voltage Rating:250V AC/DC
Withstand Voltage:1500V AC/DC
Contact Resistance:20mΩ Max
Insulation Resistance:1000MΩ Min
Operation Temperature:-40°C to +120°C
Applicable Terminal:T50801-PXX1

MATERIAL:
Insulator Material:PA66(UL94V-0)

UNLESS OTHERWISE SPECIFIED DIMENSIONS ARE IN METRIC
TOLERANCES ARE:
DECIMALS Angle
X.X:±0.40 ±3°
X.XX:±0.25
X.XXX:±0.15

SCALE	1:1
UNIT	MM
PROJ.	
SHEET	

A0	2018/06/25	NEW	Jason.Huang		Jason.Huang
REV	DATE	MODIFICATION DESCRIPTIO	DRAW	CHANGE	APPROVE



PART NUMBER CODING
T50801-P XX 1

Contact plating
 SN: Tin

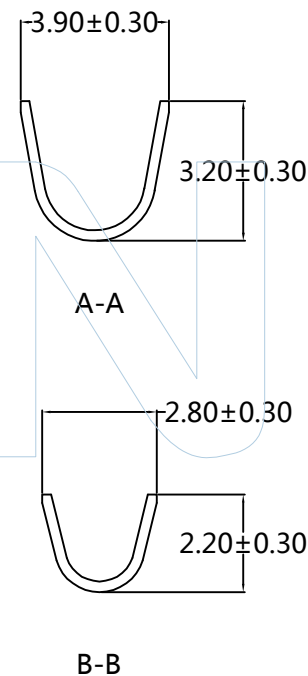
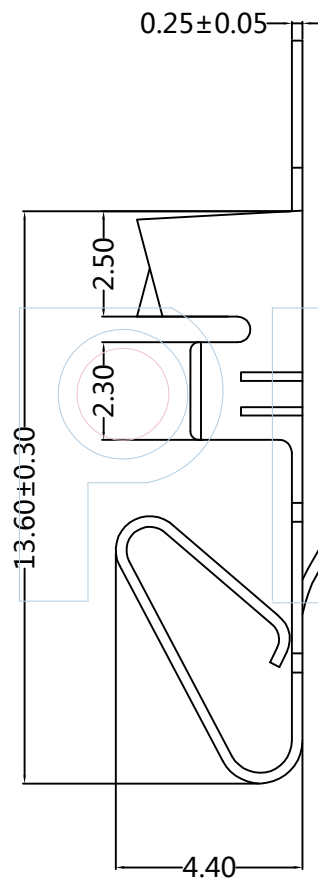
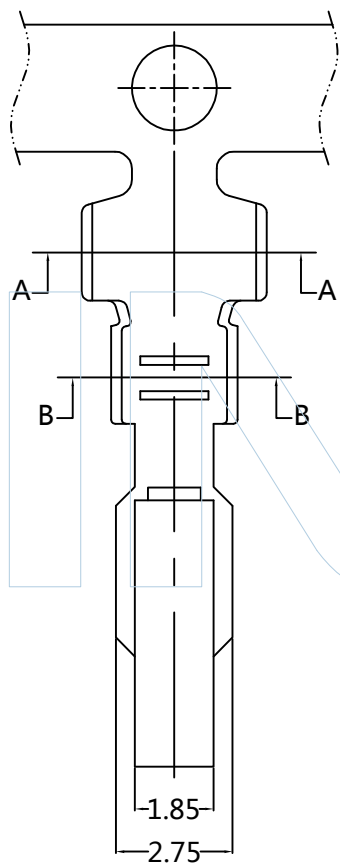

Tel: +86 769 82581808
 E-Mail: sales@winpin.net

FAX: +86 769 81766192
 Http: www.winpin.net

PART NO: T50801-PXX1

TITLE: 5.08mm TERMINAL

NOTES:
 Current Rating: 5.0AMP
 Voltage Rating: 250V AC/DC
 Withstand Voltage: 1500V AC/DC
 Contact Resistance: 20mΩ Max
 Insulation Resistance: 1000MΩ Min
 Operation Temperature: -40°C to +120°C
 Applicable Wire: AWG#18~#24
 Applicable Housing: H50801-1XXX1

MATERIAL:
 Contact Material: Phosphor Bronze
 Contact Plating: Au or Sn over Ni

UNLESS OTHERWISE SPECIFIED DIMENSIONS ARE IN METRIC
 TOLERANCES ARE:
 DECIMALS Angle
 XX: ±0.40 ±3°
 XXX: ±0.25
 XXXX: ±0.15

SCALE 1:1
 UNIT MM
 PROJ.
 SHEET

A0	2018/06/25	NEW	Jason.Huang		Jason.Huang
REV	DATE	MODIFICATION DESCRIPTION	DRAW	CHANGE	APPROVE

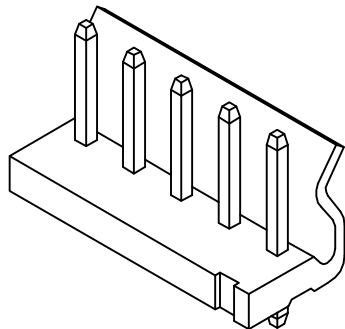

Circuit 1

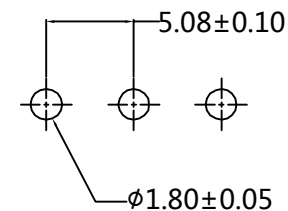
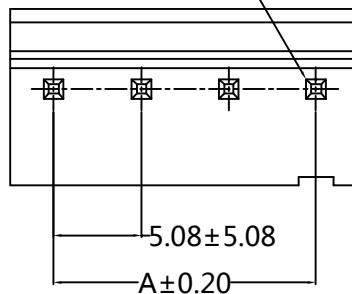

Recommended P.C.B Layout(Top Side)
(PCB BOARD TOLERANCE±0.05)

PART NUMBER CODING

W50801-1 XX S XX X X 1

No. of pins
02P-20P

Contact plating
G2:5U*Gold
SN:Tin

Color
W=White

Packing
B=PE Bag

Poles	Dimensions		Poles	Dimensions	
	A	B		A	B
02P	5.08	10.16	12P	55.88	60.96
03P	10.16	15.24	13P	60.96	66.04
04P	15.24	20.32	14P	66.04	71.12
05P	20.32	25.40	15P	71.12	76.20
06P	25.40	30.48	16P	76.20	81.28
07P	30.48	35.56	17P	81.28	86.36
08P	35.56	40.64	18P	86.36	91.52
09P	40.64	45.64	19P	91.52	96.52
10P	45.64	50.80	20P	96.52	101.60
11P	50.80	55.88			

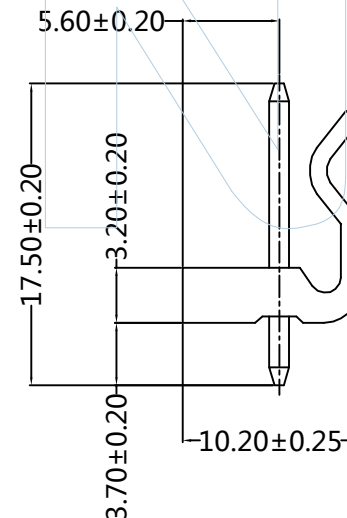
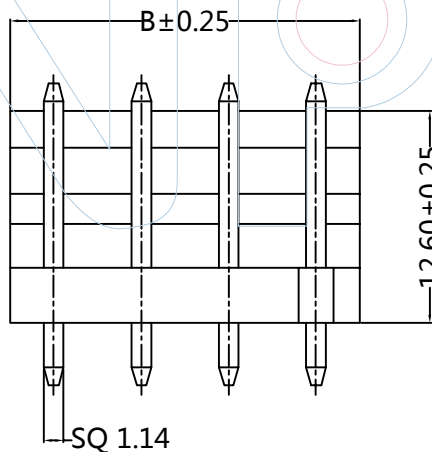

Tel: +86 769 82581808 FAX: +86 769 81766192
E-Mail: sales@winpin.net Http: www.winpin.net

PART NO: W50801-1XXSXXXX1

TITLE: 5.08mm Wafer 180°

NOTES:
Current Rating:5.0AMP
Voltage Rating:250V AC/DC
Withstand Voltage:1500V AC/DC
Contact Resistance:20mΩ Max
Insulation Resistance:1000MΩ Min
Operation Temperature:-25°C ~ +85°C
Applicable Housing:H50801-1XXX1
Applicable Terminal:T50801-PXX1

MATERIAL:
Contact Material:Brass
Contact Plating:Au or Sn over Ni
Insulator Material:PA66(UL94V-2)

UNLESS OTHERWISE SPECIFIED DIMENSIONS ARE IN METRIC
TOLERANCES ARE:
DECIMALS Angle
X.X:±0.40 ±3°
X.XX:±0.25
X.XXX:±0.15

SCALE	1:1
UNIT	MM
PROJ.	
SHEET	

A0	2015/06/25	NEW	Hua.ZT		Hua.ZT
REV	DATE	MODIFICATION DESCRIPTIO	DRAW	CHANGE	APPROVE



Recommended P.C.B Layout(Top Side)
(PCB BOARD TOLERANCE±0.05)

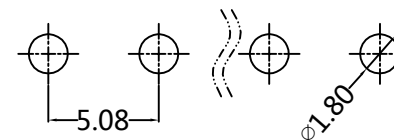

PART NUMBER CODING

W50801-1 XX R SN W B 1

No. of pins: 02P-10P
Contact plating: SN: Tin
Color: W=White
Packing: B=PE Bag

Pins	Dimensions	
	A	B
02P	5.08	10.16
03P	10.16	15.24
04P	15.24	20.32
05P	20.32	25.40
06P	25.40	30.48
07P	30.48	35.56
08P	35.56	40.64
09P	40.64	45.72
10P	45.64	50.80

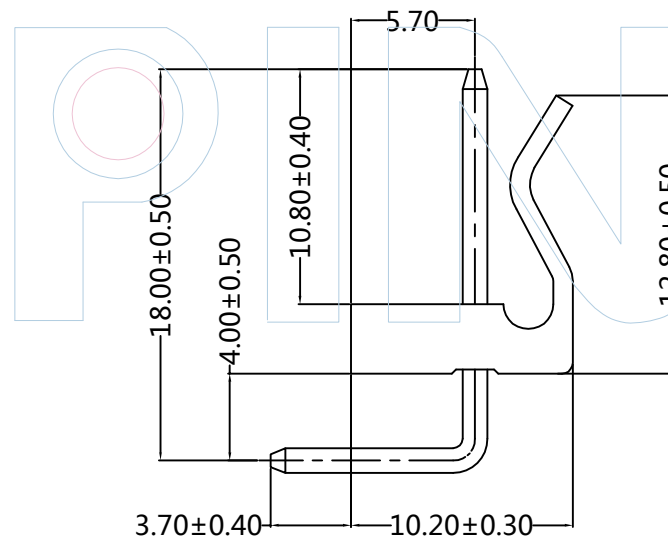
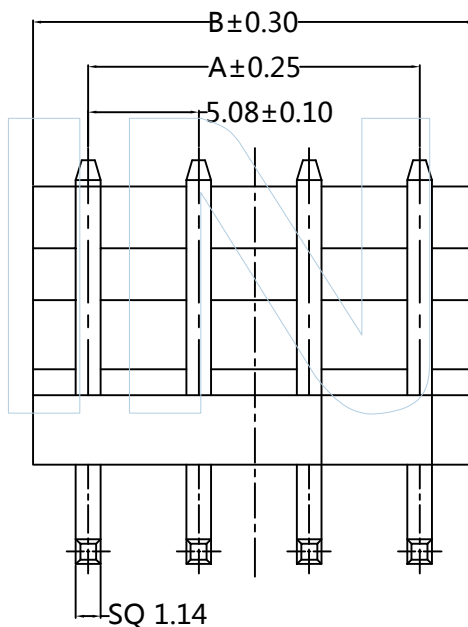

Tel: +86 769 82581808 FAX: +86 769 81766192
E-Mail: sales@winpin.net Http: www.winpin.net

PART NO: W50801-1XXRSNW B1

TITLE: 5.08mm Wafer 90°

NOTES:
Current Rating:5.0AMP
Voltage Rating:250V AC/DC
Withstand Voltage:1500V AC/DC
Contact Resistance:20mΩ Max
Insulation Resistance:1000MΩ Min
Operation Temperature:-25°C~ +85°C
Applicable Housing:H50801-1XX X1
Applicable Terminal:T50801-PXX1

MATERIAL:
Contact Material:Brass
Contact Plating:Sn over Ni
Insulator Material:PA66(UL94V-2)

UNLESS OTHERWISE SPECIFIED DIMENSIONS ARE IN METRIC
TOLERANCES ARE:
DECIMALS Angle
X.X:±0.40 ±3°
X.XX:±0.25
X.XXX:±0.15

SCALE	1:1	A0	2015/06/25	NEW	ChaoLong.Yuan	ChaoLong.Yuan	
UNIT	MM	REV	DATE	MODIFICATION DESCRIPTION	DRAW	CHANGE	APPROVE
PROJ.							
SHEET							